

# JF506E (JA5A-EL / 09A)

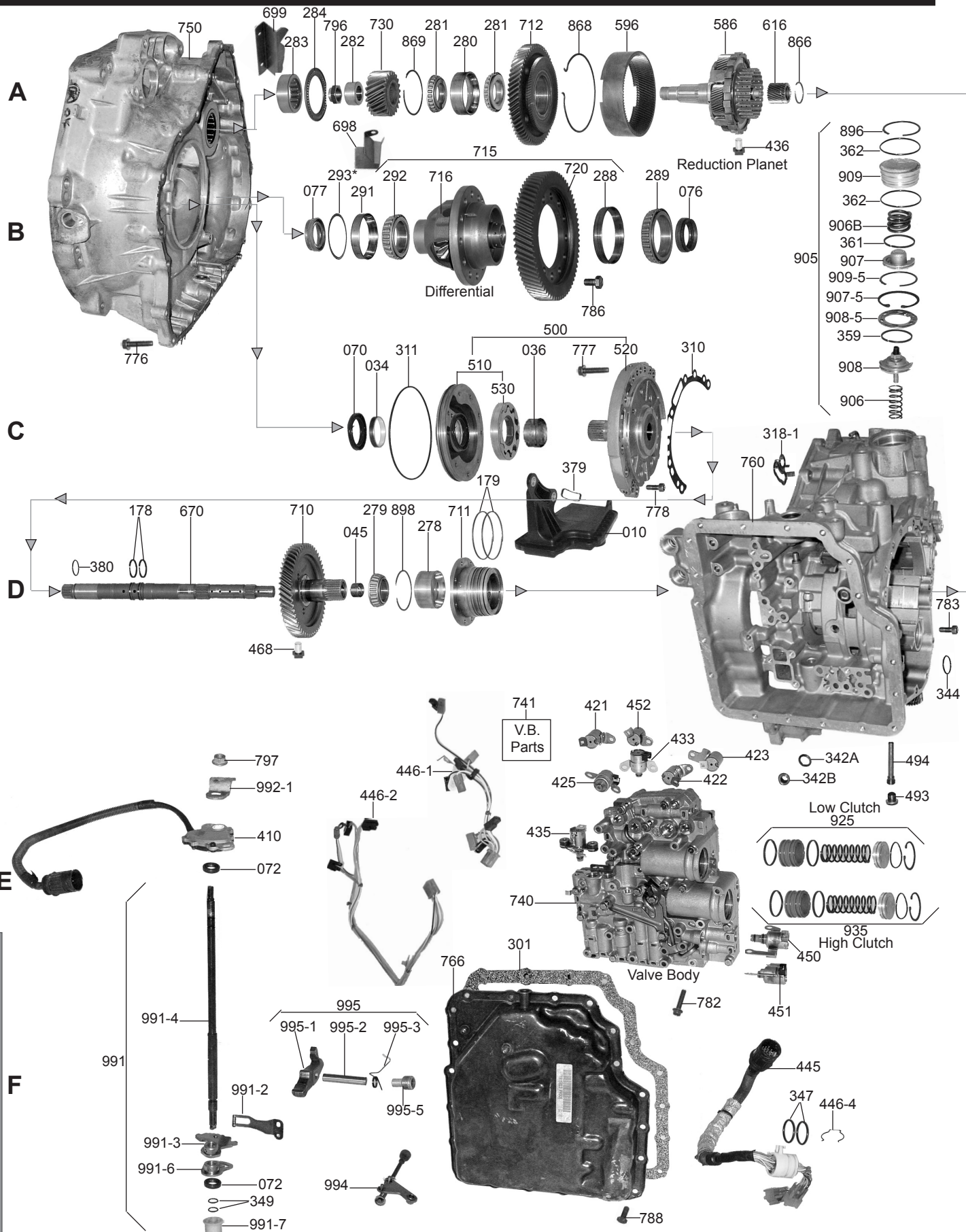

FWD 5 Speed



JATCO / NISSAN

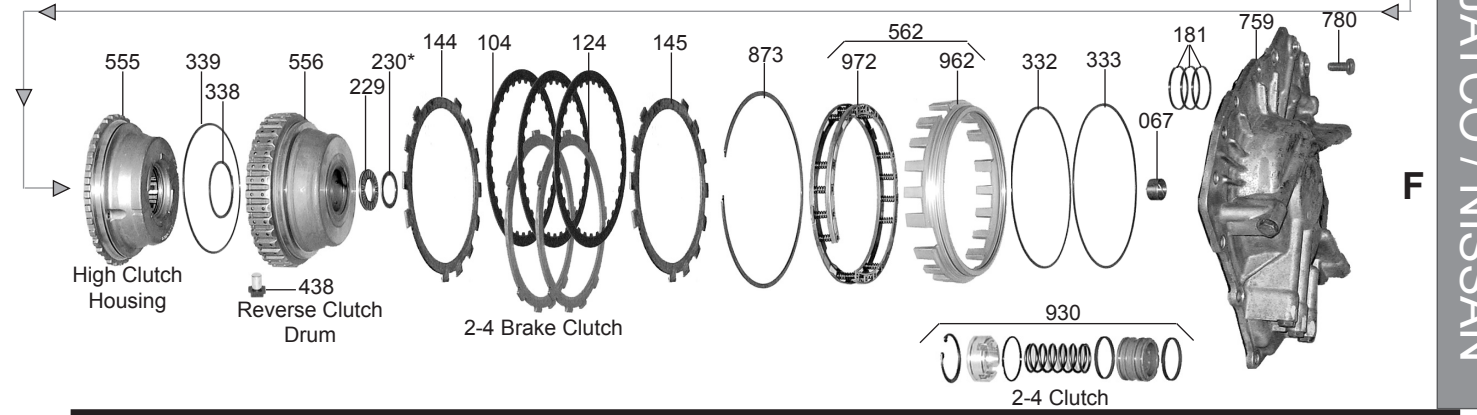
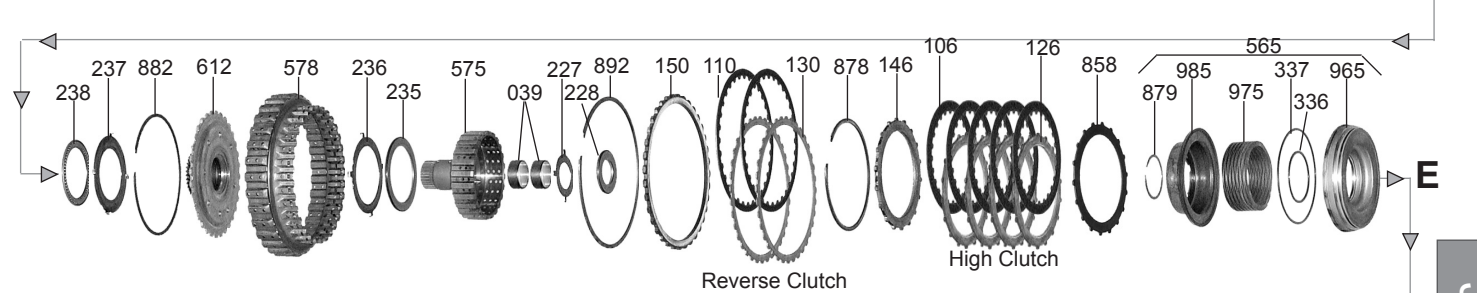
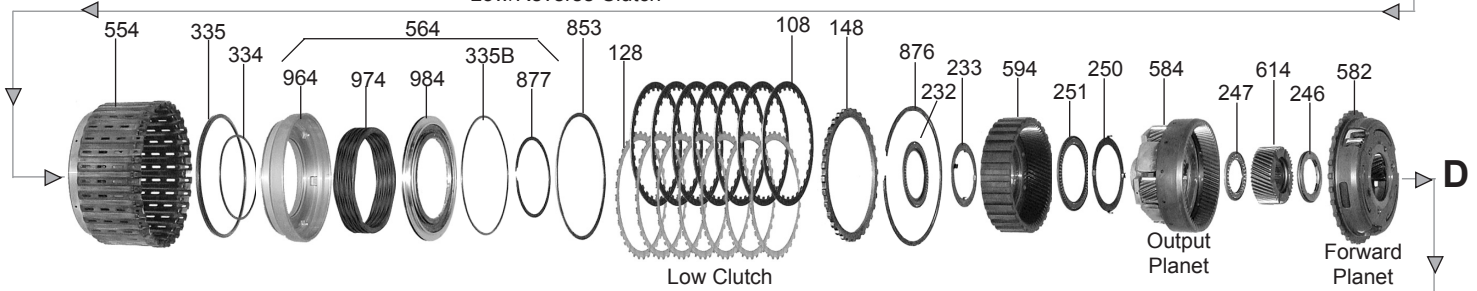
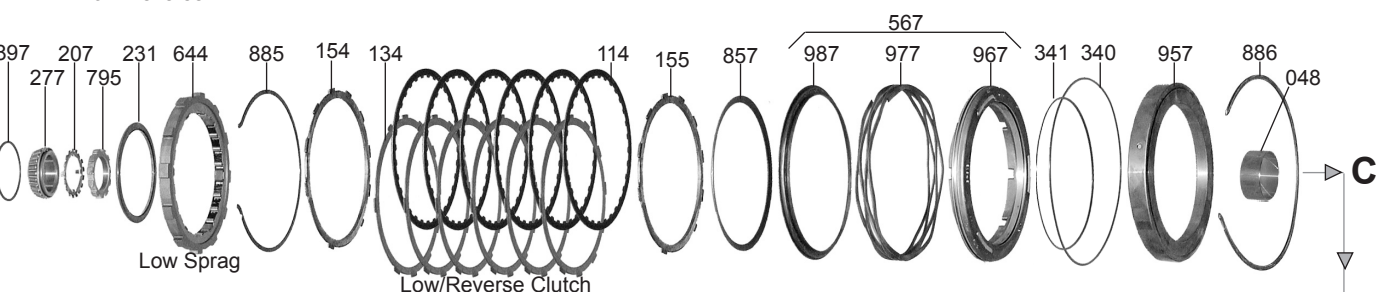
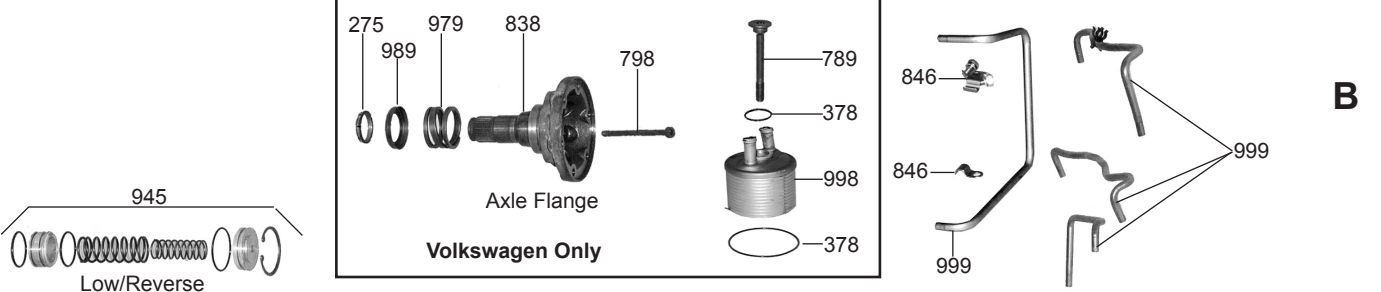
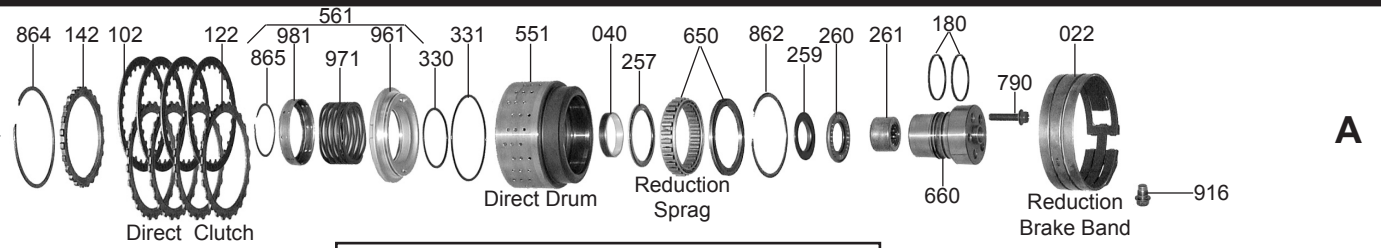

JATCO / NISSAN

# JF506E (JA5A-EL / 09A)



FWD 5 Speed

PART #	PAPER & RUBBER KIT	QTY	REFERENCE #
183000A	Paper & Rubber Kit, JF506E (All) 2002-Up	1	

PART #	OVERHAUL KIT	QTY	REFERENCE #
183002AP	Overhaul Kit, JF506E (All) (W/Bonded Retainer/Piston #985) 2002-Up	1	
183002BP	Overhaul Kit, JF506E (Mazda/Jaguar/Land Rover)(W/Bonded Retainer/Piston #985) 2002-Up	1	

PART #	MASTER L/STEELS KIT	QTY	REFERENCE #
183004AP	Master L/Steels Kit, JF506E (All) (W/Bonded Retainer/Piston #985) 2002-Up	1	
183004BP	Master L/Steels Kit, JF506E (Mazda/Jaguar/Land Rover)(W/Bonded Retainer/Piston #985) 2002-Up	1	

PART #	MASTER W/STEELS KIT	QTY	REFERENCE #
183006AP	Master W/Steels Kit, JF506E (All) (W/Bonded Retainer/Piston #985) 2002-Up	1	
183006BP	Master L/Steels Kit, JF506E (Mazda/Jaguar/Land Rover)(W/Bonded Retainer/Piston #985) 2002-Up	1	

PART #	FILTERS	QTY	REFERENCE #
183010A	Filter, JF506E (Freelander, Mazda, Jaguar) (With Round Pick-Up) 2002-Up	1	
183010C	Filter, JF506E (Volkswagen) (With Rectangel Pick-Up) 2002-Up	1	
183010CA	Filter, JF506E (Volkswagen Sharon & Ford Galaxie)(Foreign) 2002-Up	1	

PART #	BANDS	QTY	REFERENCE #
183022A	Band, JF506E (All) Reduction Brake (1.460" Wide) 2002-Up	1	

PART #	BUSHINGS	QTY	REFERENCE #
183030A	Bushing Kit, JF506E (All) 2002-Up	1	
183034A	Use 83034A	1	
83034A	Bushing, JF506E (All) Pump Body (1.775"OD)(1.654"ID) 2002-Up	1	
183036A	Bushing, JF506E (All) Stator (1.040"OD)(.925"ID) 2002-Up	1	
183039A	Bushing, JF506E (All) High Clutch Hub (.432" Tall) .885"OD (.790"ID) 2002-Up	2	
183040A	Bushing, JF506E (All) Direct Drum (.610" Wide) 1.990"OD (1.855"ID) 2002-Up	1	
183045A	Bushing, JF506E (All) Drive Transfer Gear (Rear) .985"OD (.865"ID) (Bronze) 2002-Up	1	
183048A	Bushing, JF506E (All) Low Clutch Drum (3.135"OD) 3.070"ID (12 Holes) (Babbitt) 2002-Up	1	
183067A	Bushing, JF506E (All) Rear Cover (.745"OD, .625"ID) 2002-Up	1	

PART #	METAL CLAD SEALS	QTY	REFERENCE #
183070A	Use 83070A	1	
83070A	Seal, JF506E (All) Front (2.335"OD) 2002-Up	1	
183072A	Seal, JF506E (All) Shift Lever (.975"OD, .560"ID) 2002-Up	1-2	
183076A	Seal, JF506E (Freelander) Axle (Case Side) No Flange (2.285"OD, 1.550"ID) 2002-Up	1	
	(The Seal For The Bell Housing Side Is In The Transfer Case And Does Not Come In The Transmission Kits)		
183076B	Seal, JF506E (Mazda) Axle (Both Sides) (2.207"OD, 1.550"ID) 2002-Up	2	
183076C	Seal, JF506E (Volkswagen) Axle (Both Sides) (2.830"OD, 2.270"ID) 2002-Up	2	
183076D	Seal, JF506E (Jaguar) Axle (Case Side) (With Flange) (2.285"OD, 1.550"ID) 2002-Up	1	
183077D	Seal, JF506E (Jaguar) Axle (Bell Housing Side) (2.680"OD, 2.150"ID) 2002-Up	1	

PART #	FRICTION CLUTCH	QTY	REFERENCE #
183102A	Friction, JF506E (All) Direct Clutch (.069") 24 Teeth (4"OD) 2002-Up	3-4	
183104A	Friction, JF506E (All) 2-4 Brake Clutch (.063") 32 Teeth (7 1/2"OD) 2002-Up	3	
183106A	Use 83106BA	5	
83106BA	Friction, JF506E (All) High Clutch (.063") 24 Teeth (4.400"OD) 2002-Up	5	
23108E	Friction, JF506E (All) Low Clutch (.070") 30 Teeth (5 7/16"OD) 2002-Up	6-7	
183110A	Friction, JF506E (All) Reverse Clutch (.063") 32 Teeth (6 1/8"OD) 2002-Up	2	
183114A	Use 83114BA	5-6	
83114BA	Friction, JF506E (All) Low/Reverse Clutch (.071") 32 Teeth (6.500"OD) 2002-Up	5-6	
183119A	Friction Module, JF506E (All) 2002-Up	1	

JATCO / NISSAN



FWD 5 Speed



# JF506E (JA5A-EL / 09A)

PART #	STEEL CLUTCH	QTY	REFERENCE #
183122A	Steel, JF506E (All) Direct Clutch (.079") 24 Teeth (3 3/8"ID) 2002-Up	4-5	
183124A	Steel, JF506E (All) 2-4 Brake Clutch (.118") 7 Teeth (6 5/8"OD) 2002-Up	2	
183126A	Steel, JF506E (All) High Clutch (.095") 18 Teeth (3.608"ID) 2002-Up	4	
183126B	Steel, JF506E (All) High Clutch (.062") 18 Teeth (3.608"ID) 2002-Up	4	
183128A	Steel, JF506E (All) Low Clutch (.055") 32 Teeth (4.845"ID) 2002-Up	6-7	
183130A	Steel, JF506E (All) Reverse Clutch (.079") 36 Teeth (5 5/8"OD) 2002-Up	2	
183134A	Steel, JF506E (All) Low/Reverse Clutch (.055") 10 Teeth (5.910"ID) 2002-Up	5-6	
183139A	Steel Module, JF506E (All) 2002-Up	1	

PART #	PRESSURE PLATES	QTY	REFERENCE #
183142A	Pressure Plate, JF506E (Freelander/Volkswagen) Direct Clutch (Top) .163" (24 Teeth) (3.385"ID) 2002-Up	1	
183142B	Pressure Plate, JF506E (Mazda) Direct Clutch (Top) .171" (24 Teeth) (3.385"ID) 2002-Up	1	
183142D	Pressure Plate, JF506E (Jaguar) Direct Clutch (Top) .178" (24 Teeth) (3.385"ID) 2002-Up	1	
183144A	Use 183145AB	1	
183145AA	Apply Plate, JF506E (Freelander/Volkswagen) 2-4 Brake Clutch (.140") 7 Teeth (6 5/8"ID) 2002-Up	1	
183145AB	Apply Plate, JF506E (Freelander/Volkswagen) 2-4 Brake Clutch (.163") 7 Teeth (6 5/8"ID) 2002-Up (Also Fits Pressure Plate, JF506E (All) 2-4 Brake Clutch #144 2002-Up)	1-2	
183145BA	Apply Plate, JF506E (Mazda/Jaguar) 2-4 Brake Clutch (.298") 7 Teeth (6 5/8"ID) 2002-Up	1	
183145BB	Apply Plate, JF506E (Mazda/Jaguar) 2-4 Brake Clutch (.308") 7 Teeth (6 5/8"ID) 2002-Up	1	
183146AA	Pressure Plate, JF506E (All) High Clutch (.118") 18 Teeth (3.610"ID) 2002-Up	1	
183146AB	Pressure Plate, JF506E (All) High Clutch (.126") 18 Teeth (3.610"ID) 2002-Up	1	
183146AC	Pressure Plate, JF506E (All) High Clutch (.134") 18 Teeth (3.610"ID) 2002-Up	1	
183146AD	Pressure Plate, JF506E (All) High Clutch (.142") 18 Teeth (3.610"ID) 2002-Up	1	
183148A	Pressure Plate, JF506E (Freelander/Volkswagen/Mazda) Low Clutch (.170") 32 Teeth (4.845"ID) 2002-Up	1	
183148D	Pressure Plate, JF506E (Jaguar) Low Clutch (.160") 32 Teeth (4.845"ID) 2002-Up	1	
183150AA	Pressure Plate, JF506E (All) Reverse Clutch (.141") 36 Teeth (5.615"ID) 2002-Up	1	
183150AB	Pressure Plate, JF506E (All) Reverse Clutch (.150") 36 Teeth (5.615"ID) 2002-Up	1	
183150AC	Pressure Plate, JF506E (All) Reverse Clutch (.157") 36 Teeth (5.615"ID) 2002-Up	1	
183150AD	Pressure Plate, JF506E (All) Reverse Clutch (.165") 36 Teeth (5.615"ID) 2002-Up	1	
183154A	Pressure Plate, JF506E (Freelander/Jaguar/Volkswagen) Low/Reverse Clutch (Top) 10 Teeth (.148" Thick) (Stepped) 2002-Up	1	
183154B	Pressure Plate, JF506E (Mazda) Low/Reverse Clutch (Top) 10 Teeth (.250" Thick) (Stepped) 2002-Up	1	
183155A	Apply Plate, JF506E (Freelander/Jaguar/Mazda) Low/Reverse Clutch (.092" Thick) 10 Teeth (5.910"ID) (Flat) 2002-Up	1	
183155C	Apply Plate, JF506E (Volkswagen) Low/Reverse Clutch (.100" Thick) 10 Teeth (5.910"ID) (Flat) 2002-Up	1	

PART #	SEALING RINGS	QTY	REFERENCE #
183175A	Ring Kit, JF506E (All) 2002-Up	1	
183178AT	Ring, JF506E (All) Input Shaft (1.040"OD) (Teflon) 2002-Up	1	
183179AT	Ring, JF506E (All) Low Clutch (3.065"OD) (Vespel) 2002-Up (Lap Joint)	2	
183180AT	Ring, JF506E (All) Direct Clutch (On Support #660) .090" Thick (2.050"OD) Lap Joint (Vespel) 2002-Up	1	
183181AT	Ring, JF506E (All) Reverse Clutch (In Rear Cover) 1.750"OD (V Joint) Teflon 2002-Up	3	

PART #	WASHERS & BEARINGS	QTY	REFERENCE #
183207A	Lock Washer, JF506E (All) Sits Under Nut #795 2002-Up	1	
183227A	Race, JF506E (All) High Clutch Hub To Reverse Clutch Housing (4 Tab) (.032" Thick) 1.775"OD (1.080"ID) 2002-Up	1	
183228A	Bearing W/Race, JF506E (All) High Clutch Hub To Reverse Clutch Housing (.132" Thick) 1.810"OD (1.010"ID) 2002-Up	1	
183229A	Bearing W/Race, JF506E (All) Reverse Clutch Drum To Rear Cover (1.40" Thick) 1.725"OD (.910"ID) 2002-Up	1	
183230AA	Race, JF506E (All) Reverse Clutch Drum To Rear Cover (Selective) 1.660"OD (.982"ID) 2002-Up	1	
183231A	Bearing W/Race, JF506E (All) Support To Low Drum (.158" Thick) 4.355"OD (3.765"ID) 2002-Up	1	
183232A	Bearing W/Race, JF506E (All) Support To Output Ring Gear (.110" Thick) 2.830"OD (1.965"ID) 2002-Up	1	
183233A	Race, JF506E (All) Support To Output Ring Gear (.032" Thick) 2.740"OD (4 Tab) 2002-Up	1	
183235A	Use 183251A	1	

JATCO / NISSAN

# JF506E (JA5A-EL / 09A)



FWD 5 Speed

PART #	WASHERS & BEARINGS (Continued)	QTY	REFERENCE #
183236A	Race, JF506E (All) Forward Sun Gear Hub To High Clutch Hub (4 Tab) .032" Thick (3.150"OD) 2.360"ID 2002-Up	1	
183237A	Race, JF506E (All) Forward Planet To Forward Sun Gear Hub (4 Tab) .032" Thick (3.150"OD) 2.073"ID 2002-Up	1	
183238A	Bearing W/Race, JF506E (All) Forward Planet To Forward Sun Gear Hub (.110" Thick) 2.750"OD (2.055"ID) 2002-Up	1	
183246A	Bearing W/Races, JF506E (All) Output Sun Gear To Forward Planet (.190" Thick) 2.080"OD (1.390"ID) 2002-Up	1	
183247A	Bearing W/Race, JF506E (All) Output Planet To Output Sun Gear (.133" Thick) 2.080"OD (1.345"ID) 2002-Up	1	
183250A	Race, JF506E (Freelander) Output Ring Gear To Output Planet (4 Tab) .048" Thick (2.950"OD) 2.315"ID 2002-Up	1	
183250B	Race, JF506E (Mazda/Jaguar/Volkswagen) Output Ring Gear To Output Planet (3 Tab) (.048" Thick) 2.950"OD (2.315"ID) 2002-Up	1	
183251A	Bearing W/Race, JF506E (All) Output Ring Gear To Output Planet (.110" Thick) 3.065"OD (2.295"ID) 2002-Up (Also Fits JF506E (All) Forward Planet Sun Gear Hub To High Clutch Hub #235 2002-Up)	2	
183257A	Bearing W/Races, JF506E (All) Direct Drum To Support (.123" Thick) 2.592"OD (2.010"ID) 2002-Up	1	
183259A	Race, JF506E (Freelander) Reduction Sun Gear To Direct Drum Support (.071" Thick) (.829"ID) 2002-Up	1	
183259B	Race, JF506E (Mazda) Reduction Sun Gear To Direct Drum Support (.040" Thick) .912"ID 2002-Up	1	
183259C	Race, JF506E (Jaguar/Volkswagen) Reduction Sun Gear To Direct Drum Support (.071" Thick) (.912"ID) 2002-Up	1	
183260A	Bearing W/Race, JF506E (Freelander/Jaguar/Volkswagen) Reduction Sun Gear To Direct Drum Support (.117" Thick) (.830"ID) 2002-Up	1	
183260B	Bearing W/Race, JF506E (Mazda) Reduction Sun Gear To Direct Drum Support (.150" Thick) (.830"ID) 2002-Up	1	
183261A	Caged Needle Bearing, JF506E (All) Inside Direct Drum Support (11 Needles) Cast # NSK TORR VP1Z-1 (1.385"OD) 2002-Up (Sold With 183660A Support)	1	
183275C	Washer, JF506E (Volkswagen) Axle Flange To Differential (Split, Brass) (.250" Thick) With 6 Notches On The OD 2002-Up	1	
183277A	Use 183279A	1	
183278A	Cup Race, JF506E (All) Support To Cone Bearings #277 & #279 (Double Tapered) (1.100" Thick) (2.285"OD) 2002-Up	1	
183279A	Cone Bearing, JF506E (All) Drive Transfer Gear To Support (HFT AR35-18G, NSK TC7JP) (.685" Thick, 1.377"ID) 2002-Up (Also Fits JF506E (All) #277)	2	
183280A	Double Cup Race, JF506E (All) Sits In Driven Transfer Gear (.865" Thick, 2.835"OD) 2002-Up	1	
183281A	Cone Bearing, JF506E (All) Driven Transfer Gear To Reduction Planet Shaft (Cast # AR35-20G HTF NSK) 25 Rollers (1.377"ID) 2002-Up	2	
183282A	Inner Race, JF506E (All) Under Nut On Reduction Planet Shaft (Cast # HTF P25-43G) (1.613"OD, .983"ID) 2002-Up	1	
183283A	Caged Roller Bearing, JF506E (Freelander) Bell Housing To Reduction Planet Shaft (16 Rollers) (2.445"OD) 2002-Up	1	
183283B	Caged Roller Bearing, JF506E (Mazda/Jaguar/Volkswagen) Bell Housing To Reduction Planet Shaft (16 Rollers) 2.755"OD (With 2 Flats On The Back Side) 2002-Up	1	
183284A	Bearing W/Race, JF506E (Freelander/Jaguar) Pinion Gear To Roller Bearing #283 (.126" Thick) 2.530"OD (1.755"ID) 2002-Up	1	
183284B	Bearing W/Race, JF506E (Mazda) Pinion Gear To Roller Bearing #283 (.131" Thick) 2.530"OD (1.755"ID) 2002-Up	1	
183284C	Bearing W/Race, JF506E (Volkswagen) Pinion Gear To Roller Bearing #283 (.161" Thick) 2.530"OD (1.755"ID) 2002-Up	1	
183288A	Cup Race, JF506E (Freelander/Volkswagen) Differential Housing To Case (Cast # NSK HR32914J) (3.940"OD) 2002-Up	1	
183288B	Cup Race, JF506E (Mazda/Jaguar) Differential Housing To Case (Cast # KOYO 32913JR) (3.545"OD) 2002-Up	1	
183289A	Cone Bearing, JF506E (Freelander/Volkswagen) Differential Housing To Case (31 Rollers) (Cast # NSK HR32914J) (2.754"ID) 2002-Up	1	
183289B	Cone Bearing, JF506E (Mazda/Jaguar) Differential Housing To Case (35 Rollers) (Cast # KOYO 32913JR) (2.555"ID) 2002-Up	1	
183291A	Cup Race, JF506E (Freelander/Volkswagen) Differential Housing To Bell Housing (Cast # NSK HR32010XJ) (3.150"OD) 2002-Up	1	
183291B	Cup Race, JF506E (Mazda/Jaguar) Differential Housing To Bell Housing (Cast # KOYO STC6088) (3.465"OD) 2002-Up	1	
183292A	Cone Bearing, JF506E (Freelander/Volkswagen) Differential Housing To Bell Housing (Cast # NSK HR32010XJA3) (24 Rollers) 2002-Up	1	

JATCO / NISSAN



183292B	Cone Bearing, JF506E (Mazda/Jaguar) Differential Housing To Bell Housing	1
	(Cast # KOYO STV6088) (29 Rollers) (2.363"ID) 2002-Up	
183293AA	Shim, JF506E (Freelander/Volkswagen) Differential Bearing Race To Bell Housing	1
	(Selective) (3.140"OD) (2.735"ID) 2002-Up	
183293BA	Shim, JF506E (Mazda/Jaguar) Differential Bearing Race To Bell Housing (Selective)	1
	(3.460"OD) (3.845"ID) 2002-Up	

PART #	GASKETS & RUBBER COMPONENTS	QTY	REFERENCE #
--------	-----------------------------	-----	-------------

183301A	Gasket, JF506E (All) Side Pan 2002-Up	1
183301AF	Gasket, JF506E (All) Side Pan (Farpak) 2002-Up	1
183307C	Gasket, JF506E (Volkswagen) Servo Cover (3 Bolt) 2002-Up	1
183310A	Gasket, JF506E (All) Pump Stator To Case 2002-Up	1
183311A	O-Ring, JF506E (All) Pump Body 2002-Up	1
183320A	Gasket, JF506E (Jaguar/Land Rover/VW) Valve Body (Upper & Lower) 2002-05	2
183320B	Gasket, JF506E (Mazda) Valve Body (Upper & Lower) 2002-05	2
183338AK	Seal Set, JF506E (All) Reverse Clutch Piston Seals (Contains: # 338 & # 339) 2002-Up	1
183380A	O-Ring, JF506E (All) Input Shaft (Front) To Converter 2002-Up	1

PART #	TECHNICAL MANUALS	QTY	REFERENCE #
--------	-------------------	-----	-------------

183400A	Tech Manual, Jatco 5 Speed FWD Rebuild Procedures (ATRA)	1
183400AA	Tech Manual, JF506E (ALL) Update Handbook (ATSG)	1
183400B	Tech Manual, JF506E (Mazda) Overhaul & Repair (ATSG)	1

PART #	ELECTRICAL COMPONENTS	QTY	REFERENCE #
--------	-----------------------	-----	-------------

183410A	PRNDL Switch, JF506E (Freelander) 5 Wire (21 1/2" Long Wire Harness) 2002-Up	1
183410B	PRNDL Switch, JF506E (Mazda) 7 Wire (17" Long Wire Harness) 2002-Up	1
183410D	PRNDL Switch, JF506E (Jaguar) 9 Wire (16" Long Wire Harness) 2002-Up	1
183420A	Solenoid Kit, JF506E (Freelander, Jaguar, VW) (9 Solenoids) 1999-Up	1
183420B	Solenoid Kit, JF506E (Mazda) (9 Solenoids) 2002-Up	1
183421A	Solenoid, JF506E (Freelander/Jaguar/Volkswagen) Shift "A" (With 1 Blade Brown Connector) (1 Bolt) (1 O-Ring) 2002-Up	1
183421B	Solenoid, JF506E (Mazda) Shift "A" (With 1 Blade Brown Connector) (1 Bolt) (2 O-Rings) 2002-Up	1
183422A	Solenoid, JF506E (All) Shift "B" (With 1 Blade Brown Connector) (1 Bolt) 2002-Up	1
183423A	Solenoid, JF506E (Freelander/Jaguar/Volkswagen) Shift "C" (With 1 Blade Green Connector) (1 Bolt) 2002-Up	1
183423B	Solenoid, JF506E (Mazda) Shift "C" (With 1 Blade Green Connector) (2 Bolt) 2002-Up	1
183425A	Solenoid, JF506E (Freelander/Jaguar/Volkswagen) TCC (With 1 Blade Black Connector) (1 Bolt) 2002-Up	1
183425B	Solenoid, JF506E (Mazda) TCC (With 2 Prong White Connector) (3 Bolt) 2002-Up	1
183433A	Solenoid, JF506E (Freelander/Jaguar/Volkswagen) High Clutch (With 1 Blade Black Connector) (2 Bolt) 2002-Up	1
183433B	Solenoid, JF506E (Mazda) High Clutch (With 2 Prong Yellow Connector) (No Bolt, Held On) (With Cast Iron Bracket) 2002-Up (Also Fits JF506E (Mazda) 2-4 Brake Solenoid #450 2002-Up)	2
183435A	Solenoid, JF506E (All) Pressure Control (1 Blade Green Connector) 2 Bolt (With Ground Wire) 2002-Up	1
183436A	Sensor, JF506E (All) Output (Also Input #438 (All) And Intermediate #468 (All) (Cast # RS-324C JC7 JP) 2002-Up (#436 Reads Off Of # 586, #438 Reads Off Of #556 And #468 Reads Off Of #710)	3
183438A	Use 183436A	1
183445A	Wire Harness, JF506E (Freelander) External (26 1/2" Long) (18 Wire White Pass Through Connector, With 1 Ten Prong And 1 Eight Prong Square Connector) 2002-Up	1
183445B	Wire Harness, JF506E (Mazda) External (17 1/2" Long) (18 Wire White Pass Through Connector, With 2 Ten Prong And 2 Eight Prong Square Connectors) 2002-Up	1
183445C	Wire Harness, JF506E (Volkswagen) External (5 1/2" Long) (20 Wire Black Pass Through Connector, With 1 Ten Prong And 1 Eight Prong Square Connectors) 2002-Up	1
183445D	Wire Harness, JF506E (Jaguar) External (20" Long) (18 Wire White Pass Through Connector, With 1 Eighteen Prong Connector) 2002-Up	1
183446A-1	Solenoid Wire Harness, JF506E (Freelander/Jaguar/Volkswagen) (Internal) (10 Prong Connector With 9 One Blade Connector And A Ground) 2002-Up	1
183446A-2	Wire Harness, JF506E (Jaguar/Freelander/Mazda) (Internal) (8 Prong Yellow Connector With 3 Two Blade Connector And With Temperature Sensor) 2002-Up	1
183446A-4	Clip, JF506E (All) Holds Wire Harness Connector To Case	1
183446B-1	Solenoid Wire Harness, JF506E (Mazda) (Internal) (10 Prong Connector With 7 One Blade Connector And 2 Two Prong Connectors And A Ground) 2002-Up	1

JATCO / NISSAN

# JF506E (JA5A-EL / 09A)



FWD 5 Speed

PART #	ELECTRICAL COMPONENTS (Continued)	QTY	REFERENCE #
183446C-2	Wire Harness, JF506E (Volkswagen) (Internal) (8 Prong Red Connector With 3 Two Blade Connectors And A Temperature Sensor) 2002-Up	1	
183450A	Solenoid, JF506E (Freelander/Jaguar/Volkswagen) 2-4 Brake (With 1 Blade Yellow Connector) (2 Bolt) 2002-Up	1	
183450B	Use 183433B	1	
183451A	Solenoid, JF506E (Freelander/Jaguar/Volkswagen) Neutral Shift (With 1 Blade Black Connector) (2 Bolt) 2002-Up	1	
183451B	Solenoid, JF506E (Mazda) Neutral Shift (With 2 Prong Black Connector) (1 Bolt) 2002-Up	1	
183452A	Solenoid, JF506E (Freelander, Jaguar, Volkswagen) Reduction Timing (With 1 Blade Yellow Connector) (1 Bolt) 2002-Up	1	
183452B	Solenoid, JF506E (Mazda) Reduction Timing (With 1 Blade Yellow Connector)(1 Bolt) 2002-Up	1	
183468A	Use 183436A	1	

PART #	MISCELLANEOUS COMPONENTS	QTY	REFERENCE #
183493A	Plug, JF506E (Freelander/Volkswagen) Fluid Check (5mm Allen Head) 2002-Up	1	
183493B	Plug, JF506E (Mazda/Jaguar) Fluid Check (14mm Hex Head) 2002-Up (Also Used In All For Pressure Taps Plugs)	1	
183494A	Fluid Level Tube, JF506E (Freelander/Mazda/Jaguar) (5mm Allen Head, 2" Long) 2002-Up	1	
183494C	Fluid Level Tube, JF506E (Volkswagen) (5mm Allen Head, 3/4" Long) 2002-Up	1	

PART #	HARD PARTS	QTY	REFERENCE #
183500A	Pump Complete, JF506E (All) (32 Spline Aluminum Stator) (Cast Iron Body With 2 Flats On Inner Gear) 2002-Up	1	
183510A	Body W/Gears, JF506E (All) Pump (8 Bolt) (Cast Iron) 2002-Up (With 2 Flats On Inner Gear)	1	
183520A	Stator, JF506E (All) (Aluminum) (7 Bolts To Case) (32 Splines) 2002-Up	1	

PART #	PUMP COMPONENTS	QTY	REFERENCE #
183530A	Gear Set, JF506E Pump (.524" Thick) (9 Teeth Inner Gear With 2 Flats) 2002-Up	1	

PART #	HARD PARTS (Continued)	QTY	REFERENCE #
183551A	Drum, JF506E (Freelander) Direct Clutch (With 23 Sun Gear Splines)(.350" Inside Bottom Wall Height) 2002-Up	1	
183551AA	Drum, JF506E (Freelander) Direct Clutch (With 23 Sun Gear Splines)(.410" Inside Bottom Wall Height) 2002-Up	1	
183551B	Drum, JF506E (Mazda/Jaguar) Direct Clutch (With 31 Sun Gear Splines) (.340" Inside Bottom Wall Height) 2002-Up	1	
183551C	Drum, JF506E (Volkswagen) Direct Clutch (31 Sun Gear Splines) (.410" Inside Bottom Wall Height) 2002-Up	1	
183554A	Drum, JF506E (All) Low Clutch (6 or 7 Clutch) (32 Teeth Steels) 2002-Up	1	
183555A	Housing, JF506E (All) High Clutch (Aluminum) (2.115" Thick) (2.050"ID) (This Is The First Design) 2002-Up (Has A Step Below Where The Piston O-Ring #337 Sets 0.340" Tall)	1	
183555B	Housing, JF506E (All) High Clutch (Aluminum) (2.115" Thick)(2.050"ID)(This Is The 2nd Design) 2002-Up (Has A Step Below Where The Piston O-Ring #337 Sets 0.310" Tall)(Does Not Come With #965)	1	
183555BK	Housing & Piston, JF506E (All) High Clutch (Aluminum) (2.115" Thick)(2.050"ID) With Piston # 965 (This Is The 2nd Design) 2002-Up (Can Use Just The Housing # 183555B If Customers Piston # 965 Is Good)	1	
183556A	Drum, JF506E (All) Reverse Clutch (Stamped Steel) (36 Teeth Steels) (2.875" Tall) (1.766"ID Bore) 2002-Up	1	
183556AK	Drum Kit, JF506E (All) Reverse Clutch (Contains: All Parts From Part # 892 Snap Ring To #556 Drum (Except #965) With Frictions & Steels)	1	
183561A	Piston Kit, JF506E (Freelander/Mazda/Jaguar) Direct Clutch (.330" Thick At The Edge Of The Piston) 2002-Up	1	
183561C	Piston Kit, JF506E (Volkswagen) Direct Clutch (.270" Thick At The Edge Of The Piston) 2002-Up	1	
183562A	Piston Kit, JF506E (All) 2-4 Brake Clutch (Aluminum Piston #962 Is .250" Wide From Inner To Outer O-Ring) 2002-Up	1	
183562AA	Piston Kit, JF506E (Freelander, Mazda, Jaguar) 2-4 Brake Clutch (Aluminum Piston #962 Is .300" Wide From Inner To Outer O-Ring) 2002-Up	1	
183564A	Piston Kit, JF506E (Freelander/Volkswagen/Mazda) Low Clutch (1.260" Thick Piston) 2002-Up	1	
183564D	Piston Kit, JF506E (Jaguar) Low Clutch (1.390" Thick Piston) 2002-Up	1	
183565A	Piston Kit, JF506E (All) High Clutch (Aluminum Piston) (With Bonded Retainer) 2002-Up	1	
183567A	Piston Kit, JF506E (Freelander) Low/Reverse Clutch (.905" Thick Piston) 2002-Up	1	

JATCO / NISSAN



183567B	Piston Kit, JF506E (Mazda) Low/Reverse Clutch (.805" Thick Piston) 2002-Up	1
183567C	Piston Kit, JF506E (Volkswagen) Low/Reverse Clutch (.780" Thick Piston) 2002-Up	1
183567D	Piston Kit, JF506E (Jaguar) Low/Reverse Clutch (1.040" Thick Piston) 2002-Up	1
183575A	Clutch Hub, JF506E (All) High Clutch (24 Teeth) (2.815" Tall) 2002-Up	1
183578A	Clutch Hub, JF506E (All) 2nd Brake And Reverse Clutch (32 Teeth/32 Teeth) 2002-Up	1
183582A	Planet, JF506E (Freelander) Forward (3 Gear) (34 Teeth Sun Gear) 2002-Up	1
183582B	Planet, JF506E (Mazda/Jaguar/Volkswagen) Forward (4 Gear) (34 Teeth Sun Gear) 2002-Up	1
183584A	Planet, JF506E (Freelander) Output (4 Gear) (42 Teeth Sun Gear) (74 Teeth Ring Gear) 2002-Up	1
183584B	Planet, JF506E (Mazda/Jaguar/Volkswagen) Output (5 Gear) (42 Teeth Sun Gear) (74 Teeth Ring Gear) 2002-Up	1
183586A	Planet, JF506E (Freelander) Reduction W/Shaft (23 Teeth Sun Gear) (No Groove) (18 Parking Lugs) 2002-Up	1
183586B	Planet, JF506E (Mazda/Jaguar) Reduction W/Shaft (31 Teeth Sun Gear) (2 Groove) (18 Parking Lugs) 2002-Up	1
183586C	Planet, JF506E (Volkswagen) Reduction W/Shaft (31 Teeth Sun Gear) (1 Groove) (18 Parking Lugs) 2002-Up	1
183594A	Ring Gear, JF506E (All) Output Planet (75 Teeth) 2002-Up	1
183596A	Ring Gear, JF506E (Freelander) Reduction Planet (93 Teeth) 2 Notches (5.565"OD) 2002-Up	1
183596B	Ring Gear, JF506E (Mazda/Jaguar/Volkswagen) Reduction Planet (85 Teeth) (5.435"OD) 2002-Up	1
183612A	Sun Gear W/Hub, JF506E (All) Forward Planet (34 Teeth) (32 Outer Lugs) 2002-Up	1
183614A	Sun Gear, JF506E (All) Output Planet (42 Teeth) (20 Splines) (.910" Thick) (2.335"OD) 2002-Up	1
183616A	Sun Gear, JF506E (Freelander) Reduction Planet (32 Teeth, No Groove) (1.275" Thick) 2002-Up	1
183616B	Sun Gear, JF506E (Mazda/Jaguar) Reduction Planet (31 Teeth, 2 Groove) 2002-Up	1
183616C	Sun Gear, JF506E (Volkswagen) Reduction Planet (31 Teeth, 1 Groove) (1.255" Thick) 2002-Up	1

PART #	SPRAGS & ONE WAY CLUTCHES	QTY	REFERENCE #
--------	---------------------------	-----	-------------

183644A	Sprag, JF506E (All) Low (18 Rollers) 12 Teeth (.515" Thick) 2002-Up	1
183650A	Sprag, JF506E (All) Reduction (28 Elements) (.632" Thick) 2002-Up	1

PART #	HARD PARTS (Continued)	QTY	REFERENCE #
--------	------------------------	-----	-------------

183660A	Support, JF506E (All) Direct Drum (2.875" Tall) (1.850"OD At Bushing Surface) 2002-Up	1
183670A	Shaft, JF506E (Freelander/Volkswagen) Input (12 1/2" Long) 20 Splines (2 Rings) 2002-Up	1
183670B	Shaft, JF506E (Mazda/Jaguar) Input (12 1/2" Long) 20 Splines (3 Rings) 2002-Up	1
183698A	Oil Deflector, JF506E (Freelander) 2 Bolt 2002-Up	1
183698B	Oil Deflector, JF506E (Mazda) 2 Bolt 2002-Up	1
183698C	Oil Deflector, JF506E (Volkswagen) 2 Bolt 2002-Up	1
183698D	Oil Deflector, JF506E (Jaguar) 2 Bolt 2002-Up	1
183699A	Oil Baffle, JF506E (Freelander) For #712 (2 Bolt) (5 1/2" Long) 2002-Up	1
183699B	Oil Baffle, JF506E (Mazda) For #712 (2 Bolt) (4 1/2" Long) 2002-Up	1
183699D	Oil Baffle, JF506E (Jaguar) For #712 (2 Bolt) (4 7/8" Long) 2002-Up	1
183710A	Gear, JF506E (Freelander) Drive Transfer (54 Teeth) 5.920"OD (Fits A 2 Ring Input Shaft) #183670A) (.985"ID) 2002-Up	1
183710AA	Gear, JF506E (Jaguar) Drive Transfer (54 Teeth) 5.920"OD (Fits A 3 Ring Input Shaft) #183670B) (1.050"ID Of Ring Bore) 2002-Up	1
183710B	Gear, JF506E (Mazda) Drive Transfer (41 Teeth) 6.085"OD (Fits A 3 Ring Input Shaft) #183670B) (1.050"ID Of Ring Bore) 2002-Up	1
183710C	Gear, JF506E (Volkswagen) Drive Transfer (52 Teeth) 5.770"OD (Fits A 2 Ring Input Shaft) #183670B) (.985"ID Of Bore) 2002-Up	1
183711A	Support, JF506E (Freelander/Jaguar/Mazda) Drive Transfer Gear (4 Notches Inside) (Uses 1 Snap Ring #898) 2002-Up	1
183711C	Support, JF506E (Volkswagen) Drive Transfer Gear (No Notches Inside) (Uses 2 Snap Rings #898 & #897) 2002-Up	1
183712A	Gear, JF506E (Freelander) Driven Transfer (65 Teeth No Groove) (With Ring Gear Hub) 2002-Up	1
183712B	Gear, JF506E (Mazda) Driven Transfer (47 Teeth, 1 Groove) (With Ring Gear Hub) 2002-Up	1
183712C	Gear, JF506E (Volkswagen) Driven Transfer (67 Teeth, 1 Groove) (With Ring Gear Hub) 2002-Up	1
183712D	Gear, JF506E (Jaguar) Driven Transfer (65 Teeth, 2 Groove) (With Ring Gear Hub) 2002-Up	1
183715A	Differential, JF506E (Freelander) 67 Teeth, No Groove (With 5 Small Windows In Housing) (25 Splines For Axle) 2002-Up	1
183715B	Differential, JF506E (Mazda) 68 Teeth 4 Groove (With 2 Large Windows In Housing) 29 Roller Bearing # 292 (30 Splines For Axles) 2002-Up	1



# JF506E (JA5A-EL / 09A)



FWD 5 Speed

PART #	HARD PARTS (Continued)	QTY	REFERENCE #
183715C	Differential, JF506E (Volkswagen) 69 Teeth, No Groove (2 Large Windows In Housing)..... 1 .....	1	
	.....24 Roller Bearing #292 (30 Splines For Axles) 2002-Up		
183715D	Differential, JF506E (Jaguar) 68 Teeth, 4 Groove (With 10 Round Holes In Housing) ..... 1 .....	1	
	.....(24 Splines For Axles) 2002-Up		
183716A	Differential Housing, JF506E (Freelander) (With 5 Small Windows) (25 Splines For Axles) ..... 1 .....	1	
	.....2002-Up		
183716B	Differential Housing, JF506E (Mazda) (With 2 Large Windows) (29 Roller Bearing #292)..... 1 .....	1	
	.....(30 Splines For Axles) 2002-Up		
183716C	Differential Housing, JF506E (Volkswagen) (With 2 Large Windows) (24 Roller Bearing #292) .... 1 .....	1	
	.....(30 Splines For Axles) 2002-Up		
183716D	Differential Housing, JF506E (Jaguar) (With 10 Round Holes) (24 Splines For Axles) 2002-Up.... 1 .....	1	
183720A	Ring Gear, JF506E (Freelander) 67 Teeth, No Groove (12 Bolt) 1.245" Thick (With 2 ID ..... 1 .....	1	
	.....Grooves On The Top Side) 2002-Up		
183720B	Ring Gear, JF506E (Mazda/Jaguar) 68 Teeth, 4 Groove (12 Bolt) 1.245" Thick (With 3 ID ..... 1 .....	1	
	.....Grooves On The Top Side) 2002-Up		
183720C	Ring Gear, JF506E (Volkswagen) 69 Teeth, No Groove (12 Bolt) 1.245" Thick (No ID Groove ..... 1 .....	1	
	.....On The Top Side) 2002-Up		
183730A	Pinion, JF506E (Freelander) 22 Teeth, 4 Groove (1.540" Thick) 2002-Up..... 1 .....	1	
183730B	Pinion, JF506E (Mazda/Jaguar) 21 Teeth, 3 Groove (1.520" Thick) 2002-Up ..... 1 .....	1	
183730C	Pinion, JF506E (Volkswagen) 20 Teeth, No Groove (1.540" Thick) 2002-Up ..... 1 .....	1	
183740A	Valve Body, JF506E (Freelander) With 2 Tubes (All Stamped Steel Solenoid Brackets) ..... 1 .....	1	
	.....(With 2 Countersunk Aluminum End Caps) 2002-Up		
183740B	Valve Body, JF506E (Mazda) With 1 Tube (With 2 Cast Iron Solenoid Brackets)..... 1 .....	1	
	.....(Cast # PM SUB) 2002-Up		
183740C	Valve Body, JF506E (Jaguar/Volkswagen) With 2 Tubes (All Stamped Steel Solenoid ..... 1 .....	1	
	.....Brackets) (With 2 Flush Aluminum End Caps) 2002-Up		

PART #	VALVE BODY COMPONENTS	QTY	REFERENCE #
S183741CA-2K	Valve & Sleeve Kit, JF506E TCC Control Plunger (Sonnax)(Contains: Plunger Valve & Sleeve) .. 1 .....	1	122892-01K
S183741CAK	Valve Assembly, JF506E TCC Control (Sonnax) (Contains: Control Valve, Spring, Plunger Valve ..... 1 .....	1	
	.....& Plunger Valve Sleeve)		
S183741CPK	Valve Assembly, JF506E TCC Pressure Regulator (Sonnax) (Contains: Valve, Sleeve & Spring) ..... 1 .....	1	
	.....(Must Use T-F-122892-TL10).....		
T-F-122892-TL10	Tool For S183741CPK ..... 1 .....	1	
S183741PAK	Valve Kit, JF506E Pressure Regulator (Oversize)(Sonnax) (Contains: Valve, Spring And ..... 1 .....	1	
	.....End Plug)(Must Use Tool # T-F-122892-TL3) .....		
T-F-122892-TL	Tool For S183741PAK ..... 1 .....	1	

PART #	HARD PARTS (Continued)	QTY	REFERENCE #
183750A	Bell Housing, JF506E (Freelander) (Cast # PRO43 By Seal) 12 Bolts To Case (Round Starter ..... 1 .....	1	
	.....Hole) 2002-Up		
183750B	Bell Housing, JF506E (Mazda) (Cast # PM2 By The Seal & Filler Tube Hole) 22 Bolts To Case... 1 .....	1	
	.....(Square Starter Hole) 2002-Up		
183750C	Bell Housing, JF506E (Volkswagen) (Cast # JP JC7 091 On Bottom) 21 Bolts To Case ..... 1 .....	1	
	.....(Square Starter Hole) (External Oil Cooler On Top) 2002-Up		
183750D	Bell Housing, JF506E (Jaguar) Cast # PLO42 Inside (23 Bolts To Case) (Square Starter ..... 1 .....	1	
	.....Hole) 2002-Up.....		
183759A	Rear Cover, JF506E (Freelander/Mazda/Jaguar) (Cast # PR002)(Piston #962 Is .250" Wide ..... 1 .....	1	
	.....From Inner To Outer O-Ring) 2002-Up.....		
183759AA	Rear Cover, JF506E (Freelander, Mazda, Jaguar) (Cast # PR000)(Piston #962 Is .300" Wide ..... 1 .....	1	
	.....From Inner To Outer O-Ring) 2002-Up.....		
183759C	Rear Cover, JF506E (Volkswagen) (Cast # PW001)(Pistin #962 Is .250" Wide From Inner ..... 1 .....	1	
	.....To Outer O-Ring) 2002-Up .....		
183760A	Case, JF506E (Freelander) 21 Bolts To Bell (With Top Vent) (Uses A Snap Ring To Hold ..... 1 .....	1	
	.....In The Servo) 2002-Up		
183760B	Case, JF506E (Mazda) 22 Bolts To Case (With Top Vent) (Uses A Snap Ring To Hold In ..... 1 .....	1	
	.....The Servo) 2002-Up		
183760C	Case, JF506E (Volkswagen) 21 Bolts To Case (No Vent On Top) (Uses 3 Bolts To Hold ..... 1 .....	1	
	.....In The Servo) 2002-Up		
183760D	Case, JF506E (Jaguar) 23 Bolts To Case (No Vent On Top) (Uses A Snap Ring To Hold In..... 1 .....	1	
	.....The Servo) 2002-Up		
183766A	Pan, JF506E (Freelander) Side (2 Studs) (Dipstick Tube Is 3/4" Tall And Is At The Top In The ..... 1 .....	1	
	.....Center) 2002-Up		
183766B	Pan, JF506E (Mazda) Side (No Studs) (No Filler Tube) 2002-Up ..... 1 .....	1	
183766C	Pan, JF506E (Volkswagen) Side (4 Studs) (Filler Tube Is 3/4" Tall And Is At The Left Top Of..... 1 .....	1	
	.....Pan) (Metal Vent Is 1/4"OD Right Top) 2002-Up		

JATCO / NISSAN



183766D ..... Pan, JF506E (Jaguar) Side (3 Studs) Filler Tube Is 7/8" Tall And Is At Left Top Of Pan ..... 1  
 ..... (Plastic Vent Is 1 1/8"OD Right Top) 2002-Up

183777AK ..... Bolt Set, JF506E (All) Stator To Case (7 Pieces) 2002-Up (12mm, 1 5/8" Long) ..... 1

183778AK ..... Bolt Set, JF506E (All) Pump Stator To Body (8 Pieces) 2002-Up (5mm Allen Head, .820" Long) ..2  
 ..... Also Fits JF506E (All) Support To Case #783

183780AK ..... Bolt Set, JF506E (All) Rear Cover To Case (16 Pieces) 2002-Up ..... 1

183782AK ..... Bolt Set, JF506E (All) Valve Body To Case (11 Pieces) 2002-Up ..... 1

183783AK ..... Use 183778AK ..... 1

183786AK ..... Bolt Set, JF506E (All) Differential Ring Gear (12 Pieces) 2002-Up ..... 1

183788AK ..... Bolt Set, JF506E (All) Side Pan To Case (20 Pieces) 2002-Up ..... 1

183789C ..... Bolt, JF506E (Volkswagen) Holds External Cooler On ..... 1

183790AK ..... Bolt Set, JF506E (All) Direct Drum Support To Case (5 Pieces) (1.490" Long) 2002-Up ..... 1

183795A ..... Nut, JF506E (All) Holds Drive Transfer Gear In Case (11 Outer Teeth) (1.340"ID) 2002-Up ..... 1

183796A ..... Nut, JF506E (All) Reduction Planet Shaft (.885"ID) .553" Thick (6 Point) 2002-Up ..... 1

183798C ..... Bolt, JF506E (Volkswagen) Axle Flange To Differential (3 3/8" Long) (Both Sides) 2002-Up ..... 2

183838C ..... Axle Flange, JF506E (Volkswagen) Bell Housing Side (3 7/8" Long) 2002-Up ..... 1

183838CA ..... Axle Flange, JF506E (Volkswagen) Case Side (4 3/8" Long) 2002-Up ..... 1

183853A ..... Cushion, JF506E (All) Low Clutch (.060" Thick) (Dished) 2002-Up ..... 1

183857A ..... Cushion, JF506E (All) Low/Reverse Clutch (.061" Thick) Beveled (6 9/16"OD) 2002-Up ..... 1

183858A ..... Cushion, JF506E (All) High Clutch (.063" Thick) 18 Teeth (Dished) (3.608"ID) 2002-Up ..... 1

183862A ..... Snap Ring, JF506E (All) Holds Sprag To Drum (.040" Thick) (3.410"OD) 2002-Up ..... 1

183864A ..... Snap Ring, JF506E (All) Holds Direct Clutch Pressure Plate In Drum (.079" Thick) (4.310"OD) ..1  
 ..... 2002-Up

183865A ..... Snap Ring, JF506E (All) Holds Direct Clutch Retainer In Drum (.040" Thick) (2.305"OD) ..... 1  
 ..... 2002-Up

183866A ..... Snap Ring, JF506E (Freelander) Is A Stop For The Direct Drum (.077" Thick) (1.495"OD) ..... 1  
 ..... 2002-Up

183866B ..... Snap Ring, JF506E (Mazda/Jaguar/Volkswagen) Is A Stop For The Direct Drum (.077" Thick)..... 1  
 ..... (1.915"OD) 2002-Up

183868A ..... Snap Ring, JF506E (All) Holds Reduction Planet Ring Gear To Driven Transfer Gear ..... 1  
 ..... (.079" Thick) (5.462"OD) 2002-Up

183869A ..... Snap Ring, JF506E (All) Holds #280 Bearing Race To Driven Transfer Gear #712 (.062"  
 Thick) (3.070"OD) 2002-Up ..... 1

183873A ..... Snap Ring, JF506E (All) Holds 2-4 Brake Clutch Retainer In (.079" Thick) (8 1/16"OD) ..... 1  
 ..... 2002-Up

183876A ..... Snap Ring, JF506E (All) Holds Low Clutch Pressure Plate In (.062" Thick) (5.695"OD) ..... 1  
 ..... 2002-Up

183877A ..... Snap Ring, JF506E (All) Holds Low Clutch Spring Retainer To Drum (.052" Thick) (3.355"OD) ...1  
 ..... 2002-Up

183878A ..... Snap Ring, JF506E (All) Holds High Clutch Pressure Plate In High Clutch Housing (.079" Thick) 1  
 ..... (4.765"OD) 2002-Up

183879A ..... Snap Ring, JF506E (All) Holds High Clutch Retainer In 2002-Up ..... 1

183882A ..... Snap Ring, JF506E (All) Holds Forward Sun Gear Hub To Clutch Hub #578 (.062" Thick)..... 1  
 ..... (5.300"OD) 2002-Up

183885A ..... Snap Ring, JF506E (All) Holds Low Sprag To Case (.048" Thick) 6 15/16"OD (With Curved ..... 1  
 ..... Out Ends) 2002-Up

183886A ..... Snap Ring, JF506E (Freelander/Volkswagen) Holds Low/Reverse Clutch Housing In Case ..... 1  
 ..... (.087" Thick) 2002-Up

183886B ..... Snap Ring, JF506E (Mazda/Jaguar) Holds Low.Reverse Clutch Housing In Case ..... 1  
 ..... (.083" Thick) 2002-Up

183892A ..... Snap Ring, JF506E (All) Holds Reverse Clutch Pressure Plate In Reverse Clutch (.078" Thick) ..1  
 ..... (6 1/2"OD) 2002-Up

183896A ..... Snap Ring, JF506E (Freelander/Mazda/Jaguar) Holds Servo Cover On (.058" Thick) ..... 1  
 ..... (2.735"OD) 2002-Up

183897C ..... Snap Ring, JF506E (Volkswagen) Holds Bearing #278 To Support (.033" Thick) (2.360"OD) ..... 1  
 ..... 2002-Up

183898A ..... Snap Ring, JF506E (All) Holds Bearing Race #278 To Support (.063" Thick) (2.480"OD) ..... 1  
 ..... 2002-Up

183905A ..... Servo Assembly, JF506E (Freelander) Reduction Brake (#908 Piston Is 1.955"OD) 2002-Up ..... 1

183905B ..... Servo Assembly, JF506E (Mazda/Jaguar) Reduction Brake (#908 Piston Is 2.270"OD) ..... 1  
 ..... 2002-Up

183905C ..... Servo Assembly, JF506E (Volkswagen) Reduction Brake (3 Bolt Cover) 2002-Up ..... 1

183906A ..... Spring, JF506E (All) Reduction Brake Servo (.855"OD) (2.065" Long) 2002-Up ..... 1

183906BA ..... Spring, JF506E (Freelander/Mazda/Jaguar) Non Tapered (1.020" Long) 2002-Up ..... 1

183906BC ..... Spring, JF506E (Volkswagen) Reduction Brake Servo (Tapered) (1.020" Long) 2002-Up ..... 1

183907A ..... Piston, JF506E (Freelander/Jaguar) Reduction Brake (Straight Neck) (1.955"OD) 2002-Up ..... 1

183907A-5 ..... Snap Ring, JF506E (All) Holds Reduction Drake Servo Piston #908 In The Case (.080" Thick).....1  
 ..... 2.500"OD (With 2 Eyelets) 2002-Up

183907B ..... Piston, JF506E (Mazda/Jaguar) Reduction Brake (With Stepped Neck) (1.955"OD) 2002-Up ..... 1

# JF506E (JA5A-EL / 09A)



FWD 5 Speed

PART #	HARD PARTS (Continued)	QTY	REFERENCE #
183908A	Piston, JF506E (Freelander) Reduction Brake Servo (1.955"OD)(2.860" Long Pin) 2002-Up	1	
183908A-5	Spacer, JF506E (All) Reduction Brake Servo Piston (With 6 Oval Slots) (.126" Thick) 2.350"OD (1.505"ID) 2002-Up	1	
183908B	Piston, JF506E (Mazda/Jaguar/Volkswagen) Reduction Brake Servo (2.270"OD) (2.470" Long Pin) 2002-Up	1	
183909A	Cover, JF506E (Freelander/Mazda/Jaguar) Reduction Brake Servo (2.515"OD) 2002-Up	1	
183909A-5	Snap Ring, JF506E (All) Holds Reduction Brake Servo Piston #907 In Cover (.040" Thick) (2.140"OD) 2002-Up	1	
183909C	Cover, JF506E (Volkswagen) Reduction Brake Servo (Bolt-On Type) (1.970"ID) 2002-Up	1	
183916A	Band Anchor, JF506E (Freelander/Volkswagen) (6 Point Hex Head) 2002-Up	1	
183916B	Band Anchor, JF506E (Mazda/Jaguar) (6 Point Fluted Head) 2002-Up	1	
183925A	Accumulator Assembly, JF506E (All) Low Clutch (Upper One In Valve Body) (Plastic Piston) (End Cap Is .482" Thick, 1.612"OD) (Spring Is 3.085" Long, 1.062"OD) 2002-Up	1	
183930A	Accumulator Assembly, JF506E (All) 2-4 Brake Clutch (In Rear Cover) (Plastic Piston) (End Cap Is .640" Thick, 1.612"OD) (Spring Is 2.863" Long, 1.062"OD) 2002-Up	1	
183935A	Accumulator Assembly, JF506E (All) High Clutch (Lower One In Valve Body) (Plastic Piston) (End Cap Is .482" Thick, 1.612"OD) (Spring Is 2.905" Long, 1.062"OD) 2002-Up	1	
183945A	Accumulator Assembly, JF506E (All) Low/Reverse Clutch (In Rear Of Case) (Aluminum Piston) (End Cap Is .560" Thick, 1.635"OD) (Outer Spring Is 2.085" Long, 1.055"OD) (Inner Spring Is 2.135" Long, .785"OD) 2002-Up	1	
183957A	Housing, JF506E (Freelander/Volkswagen) Low/Reverse Clutch Piston (.805" Thick) 2002-Up	1	
183957B	Housing, JF506E (Mazda/Jaguar) Low/Reverse Clutch Piston (.850" Thick) 2002-Up	1	
183961A	Piston, JF506E (Freelander/Mazda/Jaguar) Direct Clutch (.330" Thick At The Edge) 3.980"OD (2.220"ID) 2002-Up	1	
183961C	Piston, JF506E (Volkswagen) Direct Clutch (.270" Thick At The Edge) 3.980"OD (2.220"ID) 2002-Up	1	
183962A	Piston, JF506E (All) 2-4 Brake Clutch (Aluminum W/ 20 Legs) (1.545" Thick) (7 1/2"OD) (Piston Is .300" Wide From Inner To Outer O-Ring) 2002-Up	1	
183962AA	Piston, JF506E (Freelander, Mazda, Jaguar) 2-4 Brake Clutch (Aluminum W/20 Legs) (1.545" Thick)(7 1/2"OD)(Piston Is .300" Wide From Inner To Outer O-Ring) 2002-Up	1	
183964A	Piston, JF506E (Freelander/Volkswagen/Mazda) Low Clutch (1.260" Thick) (Aluminum) 2002-Up	1	
183964D	Piston, JF506E (Jaguar) Low Clutch (1.390" Thick) (Aluminum) 2002-Up	1	
183965A	Piston, JF506E (All) High Clutch (Aluminum) (.890" Thick) 4.405"OD (1.970"ID) 2002-Up	1	
183967A	Piston, JF506E (Freelander) Low/Reverse Clutch (.905" Thick) (Aluminum) 2002-Up	1	
183967B	Piston, JF506E (Mazda) Low/Reverse Clutch (.805" Thick) (Aluminum) 2002-Up	1	
183967C	Piston, JF506E (Volkswagen) Low/Reverse Clutch (.780" Thick) (Aluminum) 2002-Up	1	
183967D	Piston, JF506E (Jaguar) Low/Reverse Clutch (1.040" Thick) (Aluminum) 2002-Up	1	
183971A	Spring, JF506E (All) Direct Clutch Return (Spiral) (2.625"OD) 2002-Up	1	
183972A	Spring, JF506E (All) 2-4 Brake Clutch Return (16 Springs) .920" Thick (6 11/16"ID) 2002-Up	1	
183974A	Spring, JF506E (All) Low Clutch Return (Spiral Type) (4.290"OD) 2002-Up	1	
183975A	Spring, JF506E (All) High Clutch Return (Spiral) 1.075" Thick (2.875"OD) 2002-Up	1	
183977A	Spring, JF506E (All) Low/Reverse Clutch Return (Spiral Type) (8"OD) 2002-Up	1	
183979C	Spring, JF506E (Volkswagen) Axle Flange To Differential (1.725"OD) (1" Tall) 2002-Up	1	
183981A	Retainer, JF506E (All) Direct Clutch Spring (2.820"OD) 2002-Up	1	
183984A	Retainer, JF506E (All) Low/Clutch Spring (.300" Thick) (Aluminum) 5.065"OD (12 ID Notches) 2002-Up	1	
183985A	Retainer/Piston, JF506E (All) High Clutch Spring (Bonded)(4.120"OD)(1.655"ID) 2002-Up	1	
183987A	Retainer, JF506E (All) Low/Reverse Clutch Spring (Tin) (7 5/16"OD) 2002-Up	1	
183989C	Retainer, JF506E (Volkswagen) Axle Flange Spring To Washer #275 (1.840"OD) With 2 Ears (Cup Retainer) 2002-Up	1	
183991A	Linkage Assembly, JF506E (Jaguar/Freelander) Internal (15 3/16" Long Rod With 2 O-Rings) 2002-Up	1	
183991A-7	Sleeve, JF506E (All) Manual Shaft To Case (Plastic) (.485"ID) 2002-Up	1	
183991B	Linkage Assembly, JF506E (Mazda) Internal (11 3/8" Long Rod With No O-Rings) 2002-Up	1	
183991C	Linkage Assembly, JF506E (Volkswagen) Internal (10 1/2" Long Rod With No O-Rings) 2002-Up	1	
183994A	Park Actuator, JF506E (Jaguar/Freelander/Mazda) 6 1/2" Long Rod With Clip 2002-Up	1	
183994C	Park Actuator, JF506E (Volkswagen) 5 3/4" Long Rod With Clip 2002-Up	1	
183995A	Park Pawl Assembly, JF506E (Jaguar/Freelander) 2002-Up	1	
183995B	Park Pawl Assembly, JF506E (Mazda) 2002-Up	1	
183995C	Park Pawl Assembly, JF506E (Volkswagen) 2002-Up	1	
183998C	Oil Cooler, JF506E (Volkswagen) External (1 Bolt, 3 3/4" Long) 2002-Up	1	
183999A	Tube Set, JF506E (Freelander/Mazda/Jaguar) Inside Case At Rear Cover (3 Pieces) 2002-Up	1	
183999A-1	Tube, JF506E (Freelander) Differential Bearing Feed (On The Back Of The Bell Housing) 2002-Up	1	

JATCO / NISSAN



183999B-1 ..... Tube, JF506E (Mazda) Differential Bearing Feed (On The Back Of The Bell Housing) ..... 1 .....  
 ..... 2002-Up  
 183999C ..... Tube Set, JF506E (Volkswagen) Inside Case At Rear Cover (3 Pieces) 2002-Up ..... 1 .....  
 183999C-1 ..... Tube, JF506E (Volkswagen) Differential Bearing Feed (On The Back Of The Bell Housing) ..... 1 .....  
 ..... 2002-Up  
 183999CC ..... Tube Set, JF506E (Volkswagen) Cooler Feed (On The Back Of The Bell Housing) (2 Pieces) .... 1 .....  
 ..... 2002-Up  
 183999D-1 ..... Tube, JF506E (Jaguar) Differential Bearing Feed (On The Back Of The Bell Housing) ..... 1 .....  
 ..... 2002-Up

**342** **JATCO 5 SPEED**

# Volkswagen

## Reverse and High Clutch Drums

Piston cracks can be caused by crossleaks between the forward and reverse clutches. Inspect closely when there is a burnt/welded clutch failure. To check for crossleaks while in the vehicle, install a pressure gauge in the reverse clutch pressure tap. There should be 0 psi when in all of the forward ranges.

*Check for cracks in this area*



© 2005 ATRA. All Rights Reserved

JATCO / NISSAN