

MAZDA

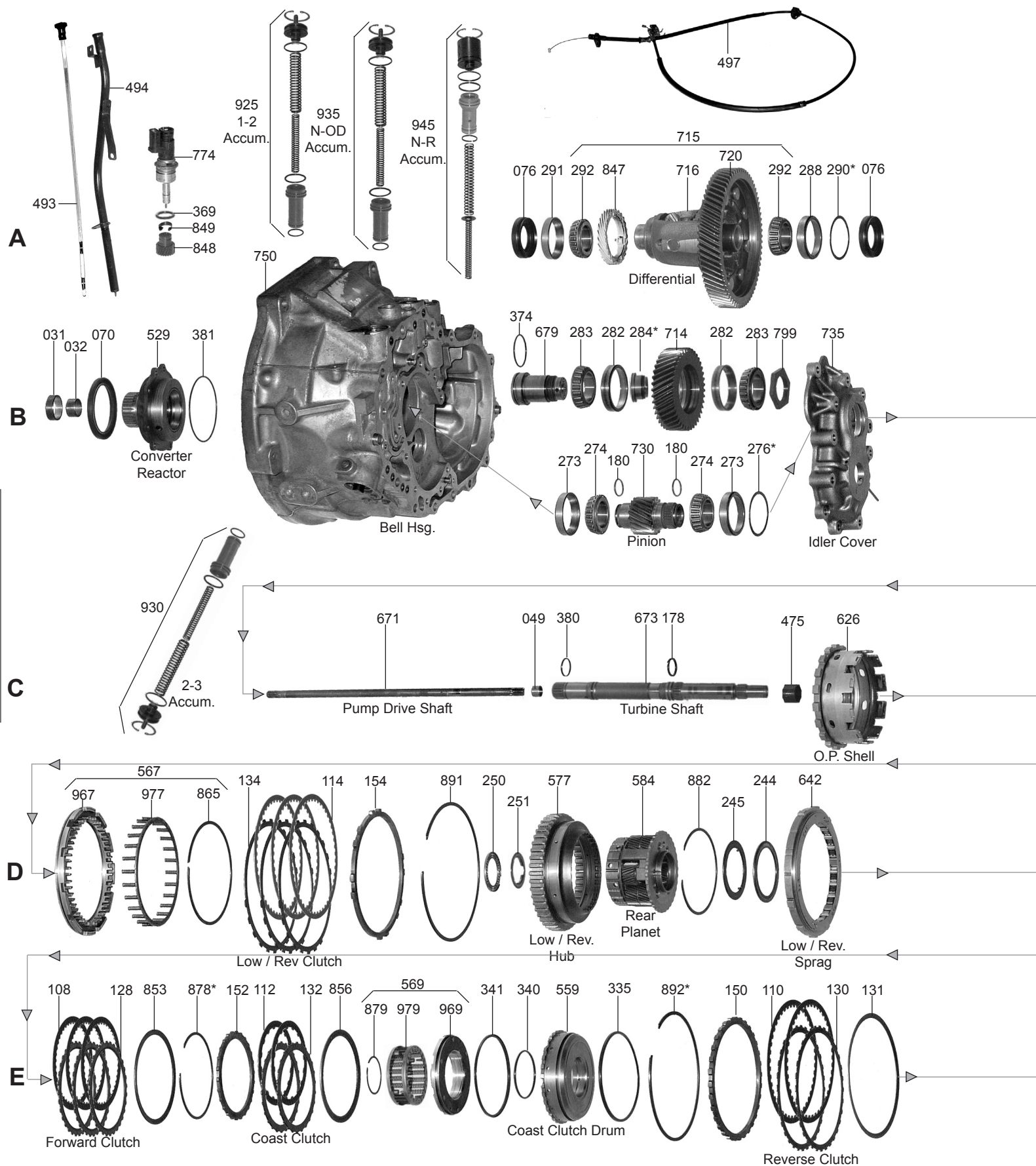

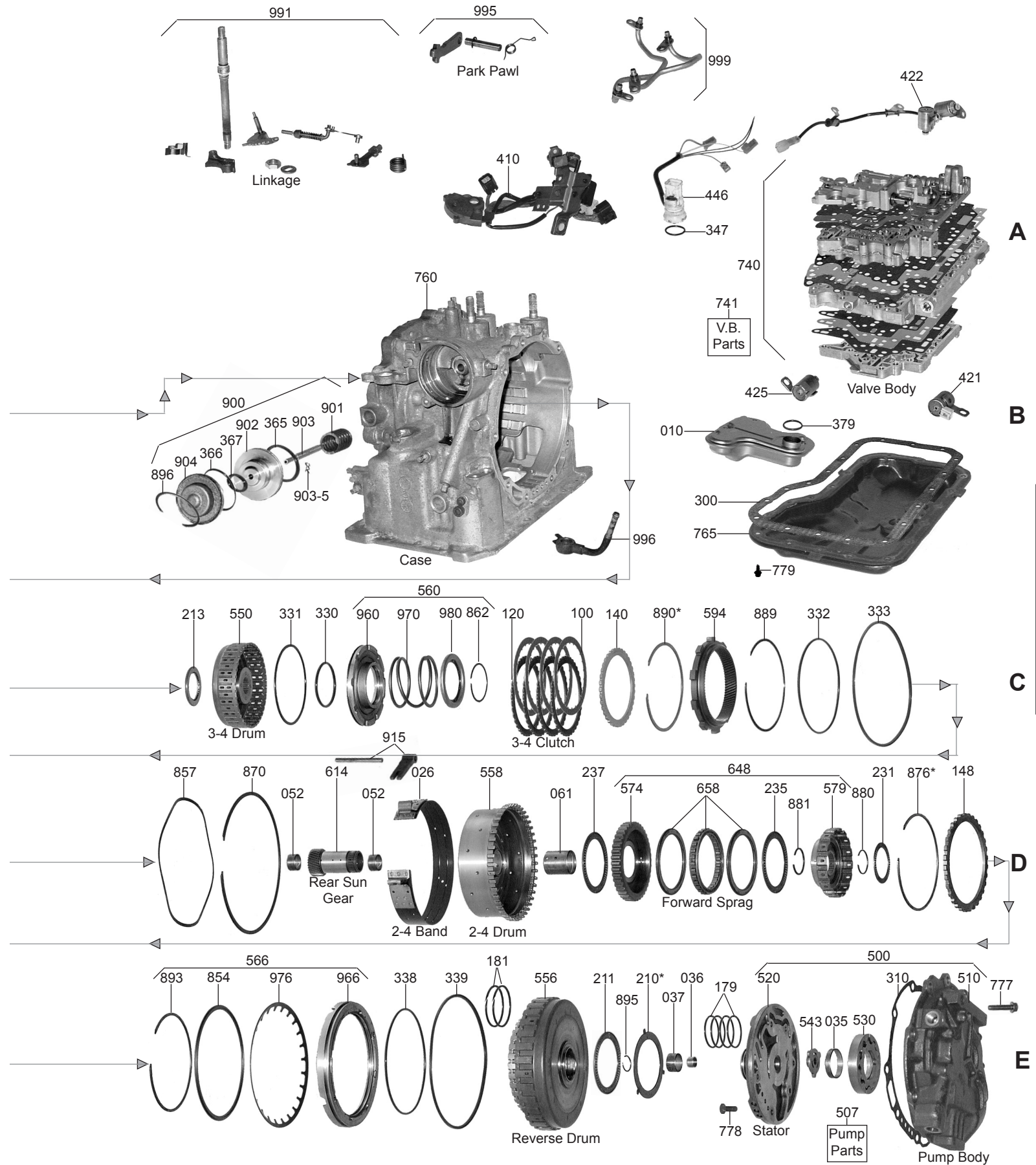

MAZDA

# F4EAT / F4A-EL / F4E



FWD 4 Speed (1 Pan)

MAZDA

PART #	PAPER & RUBBER KIT	QTY.	REFERENCE #
38000AB	Paper & Rubber Kit, F4E 1990-Up (Combo)	1	

PART #	OVERHAUL KITS	QTY.	REFERENCE #
38002AB	Overhaul Kit, F4E 1990-Up (Combo)	1	

PART #	MASTER L/STEEL KIT	QTY.	REFERENCE #
38004AB	Master L/Steels Kit, F4E 1990-Up (Combo)	1	

PART #	MASTER W/STEEL KIT	QTY.	REFERENCE #
38006AB	Master W/Steels Kit, F4E 1990-Up (Combo)	1	

PART #	FILTER	QTY.	REFERENCE #
38010A	Filter, F4E 2WD 1990-Up	1	F1CZ-7A098-A
38010B	Filter, F4E AWD (All Metal) 1990-Up	1	

PART #	FILTER KIT	QTY.	REFERENCE #
38011A	Filter Kit, F4E 1990-Up	1	

PART #	BANDS	QTY.	REFERENCE #
38026A	Band, F4E 1990-Up	1	

PART #	BUSHINGS	QTY.	REFERENCE #
38030	Bushing Kit, F4E Mazda, Ford 1990-Up	1	
28031A	Bushing, F4E Converter Hub (57.1mm) 1990-Up	1	
38032A	Bushing, F4E Converter Reactor (Small) To Turbine Shaft	1	
38035A	Bushing, F4E Inner Pump Gear 1990-Up	1	
38036	Bushing, F4E Stator (Small) For Pump Drive Shaft	1	
38037A	Bushing, F4E Stator (Large) For Turbine Shaft	1	
38052A	Bushing, F4E Sun Gear 1990-Up	2	
38061A	Bushing, F4E 2-4 Drum	1	

PART #	METAL CLAD SEALS	QTY.	REFERENCE #
28070	Seal, F4E Front (Narrow) 1990-Up	1	
28070A	Seal, F4E Front (Wide) 1990-Up	1	
28078	Seal, F4E Speed-O Shaft	1	
38076A	Seal, F4E Axle (Both Sides)(.349" Thick)(Can Use 42076A)	2	
42076A	Seal, F4E Axle (Both Sides)(.395" Thick)(Can Use 38076A)	2	
38089A	Retainer, F4E Front Seal (3 Bolt Metal)	1	

PART #	FRICTION CLUTCH	QTY.	REFERENCE #
38100A	Friction, F4E 3-4 Clutch (.062") (22 Teeth) 1990-Up	4	F1CZ-7B442-C
38108A	Friction, F4E Forward Clutch (.062") (42 Teeth) 1990-Up	3	F1CZ-7B164-6
38110A	Friction, F4E Reverse Clutch (.062") (45 Teeth) 1990-Up	2	F1CZ-7B442-A
38112A	Friction, F4E Coast Clutch (.062") (16 Teeth) 1990-Up	2	F1CZ-7B164-E
38114A	Friction, F4E Low/Reverse (.062") (48 Teeth) 1990-Up	4	F1CZ-7B442-E
38119A	Friction Module, F4E 1990-Up	1	

PART #	STEEL CLUTCH	QTY.	REFERENCE #
38120A	Steel, F4E 3-4 Clutch (.063") (38 Teeth) 1990-Up	4	
38120AA	Steel, F4E 3-4 Clutch (.071") (38 Teeth) 1990-96	4	
38120AB	Steel, F4E 3-4 Clutch (.091") (38 Teeth) 1990-97	4	
38120AC	Steel, F4E 3-4 Clutch (.130") (38 Teeth) 1998-Up	4	
38128A	Steel, F4E Forward Clutch (.063") (32 Teeth) 1990-Up	3	
38130A	Steel, F4E Reverse Clutch (.063") (32 Teeth) 1990-Up	2	
38131A	Steel, F4E Reverse Clutch (.057") 6 7/8"OD (Dished) 1990-Up	1	
38132A	Steel, F4E Coast Clutch (.063") (26 Teeth) 1990-Up	2	
38134A	Steel, F4E Low/Reverse Clutch (.063") (16 Teeth) 1990-Up	4	



PART #	CLUTCH PRESSURE PLATES	QTY.	REFERENCE #
38140A	Pressure Plate, F4E 3-4 Clutch (.140")	1	F1CZ-7B066-D
38140B	Pressure Plate, F4E 3-4 Clutch (.175")	1	
38148A	Pressure Plate, F4E Forward Clutch (.155")(32 Teeth)(4.333"ID) 1990-Up	1	
38148B	Pressure Plate, F4E Forward Clutch (.180")(32 Teeth)(4.333"ID) 1990-Up	1	
38150A	Pressure Plate, F4E Reverse Clutch	1	
38152A	Pressure Plate, F4E Coast Clutch	1	F1CZ-7B066-B
38154A	Pressure Plate, F4E Low/Reverse Clutch	1	

PART #	VALVE BODY KITS	QTY.	REFERENCE #
T38165A	Shift Kit, F4A-EL / 4EAT-F 1990-Up (Transgo)	1	SK ® F4A
A38165A	Valve Body Kit, F4A-EL (Translab)	1	

PART #	OIL SEALING RINGS	QTY.	REFERENCE #
38175A	Ring Kit, F4E Full (Metal) 1990-Up	1	
38175AT	Ring Kit, F4E Full (Teflon) 1990-Up	1	
38175B	Ring Kit, F4E Short (4 Pump Rings) Metal 1990-Up	1	
38179A	Ring, F4E Pump Stator (Metal) 1990-Up	4	
38179AT	Ring, F4E Pump Stator (Teflon) 1990-Up	4	F1CZ-7D019-A
38181AT	Ring, F4E Coast Clutch (Teflon) 1990-Up	2	
38180A	Ring, F4E Output Gear (Metal) 1990-Up	2	
38178AT	Ring, F4E Turbine Shaft (Teflon) 1990-Up	1	
38191AT	Ring, F4E 2-3 / Neutral-Overdrive (Small) Scarf Cut (Teflon) 1990-Up	2	
38191AAT	Ring, F4E Neutral-Reverse Accumulator (Small) Butt Joint (Teflon) 1990-Up	1	
38192AT	Ring, F4E 2-3 / Neutral-Overdrive / Neutral-Reverse Accumulator (Large) Scarf Cut (Teflon) 1990-Up	3	

PART #	WASHERS & BEARINGS	QTY.	REFERENCE #
38210A	Race, F4E Stator To reverse Drum (1.2mm)	1	
38210AA	Race, F4E Stator To reverse Drum (1.4mm)	1	
38210AB	Race, F4E Stator To reverse Drum (1.6mm)	1	
38210AC	Race, F4E Stator To reverse Drum (1.8mm)	1	
38210AD	Race, F4E Stator To reverse Drum (2.0mm)	1	
38210AE	Race, F4E Stator To reverse Drum (2.2mm)	1	
38211A	Bearing W/Race, F4E Stator To Reverse Drum	1	F1CZ-7F241-A
38213A	Bearing W/Race, F4E Shell To 3-4 Clutch Drum	1	F1CZ-7F404-A
38231A	Bearing W/Race, F4E Reverse Drum To Hub	1	
38235A	Bearing, F4E Drum With Sun Gear To Forward Clutch Hub	1	F1CZ-7A623-A
38237A	Bearing, F4E Band Drum To Forward Sprag	1	
38244A	Bearing, F4E Planet To Sun Gear Drum	1	
38245A	Race, F4E Planet To Sun Gear Drum	1	F1CZ-7F368-A
38250A	Race, F4E Drum To Planet	1	
38251A	Bearing W/Race, F4E Drum To Planet	1	F1CZ-7D234-A
32254	Cone Bearing, F4E Differential (Front & Rear) 1.378"ID (23 Rollers)	2	5224300
32254K	Bearing & Race Kit, F4E Differential (Front & Rear) 1.378"ID (23 Rollers)	2	
32255	Cup Race, F4E Differential (Front & Rear)	2	4567259
38273A	Cup Race, F4E Converter Reactor To Pinion Bearing	1	
38276A	Shim, F4E Pinion Cup Race To Pinion Retainer	1	
38282A	Cup Race, F4E Idler Gear	2	
38283A	Cone Bearing, F4E Idler Gear & Pinion Gear	2-4	

MAZDA



# F4EAT / F4A-EL / F4E



FWD 4 Speed (1 Pan)

PART #	WASHERS & BEARINGS (Continued)	QTY.	REFERENCE #
38284A	Shim, F4E Between Idler Gear Bearings (.150")	1	30801815
38284AA	Shim, F4E Between Idler Gear Bearings (.152")	1	30802815
38584AB	Shim, F4E Between Idler Gear Bearings (.154")	1	30803815
38284AC	Shim, F4E Between Idler Gear Bearings (.156")	1	30804815
38284AD	Shim, F4E Between Idler Gear Bearings (.158")	1	30805815
38284AE	Shim, F4E Between Idler Gear Bearings (.159")	1	30806815
38284AF	Shim, F4E Between Idler Gear Bearings (.161")	1	30807815
38284AG	Shim, F4E Between Idler Gear Bearings (.163")	1	
38284AH	Shim, F4E Between Idler Gear Bearings (.165")	1	
38284AJ	Shim, F4E Between Idler Gear Bearings (.167")	1	
38284AK	Shim, F4E Between Idler Gear Bearings (.169")	1	
38284AL	Shim, F4E Between Idler Gear Bearings (.171")	1	
38284AM	Shim, F4E Between Idler Gear Bearings (.173")	1	
38284AN	Shim, F4E Between Idler Gear Bearings (.175")	1	
38284AP	Shim, F4E Between Idler Gear Bearings (.177")	1	
38284AQ	Shim, F4E Between Idler Gear Bearings (.179")	1	
38284AR	Shim, F4E Between Idler Gear Bearings (.181")	1	
38284AS	Shim, F4E Between Idler Gear Bearings (.183")	1	
38284AT	Shim, F4E Between Idler Gear Bearings (.185")	1	
38284AU	Shim, F4E Between Idler Gear Bearings (.187")	1	
38288A	Cup Race, F4E Differential (Rear) (Use 32255)	1	
38289A	Cone Bearing, F4E Differential (Rear) (Use 32254)	1	
38290A	Shim, F4E Differential Cup Race To Case	1	
38291A	Cup Race, F4E Differential (Front) (Use 32255)	1	
38292A	Cone Bearing, F4E Differential (Front) (Use 32254)	1	

PART #	GASKETS & RUBBER COMPONENTS	QTY.	REFERENCE #
38300A	Gasket, F4E Pan (19 Holes) 1990-Up (Cork)	1	
38300AF	Gasket, F4E Pan (19 Holes) 1990-Up (Farpak)	1	
38310A	Gasket, F4E Front Pump 1990-Up	1	
38320AK	Gasket Kit, F4E Valve Body 1990-97	1	
38320BK	Gasket Kit, F4E Valve Body 1998-Up (All Except Kia)	1	
38350A	O-Ring, F4E 1-2 / 2-3 / Neutral-Overdrive / Neutral-Reverse Accumulator Stop (Cover)	4	
38351A	D-Ring, F4E 1-2 Accumulator (Small)	1	
38352A	D-Ring, F4E 1-2 Accumulator (Large)	1	
38369A	O-Ring, F4E Speed-O Housing To Case O-Ring 1990-Up	1	
38379A	D-Ring, F4E Filter O-Ring	1	
38381A	O-Ring, F4E Converter Reactor	1	
38390	External Seal Kit, F4E/F4EAT/F4A-EL With Seals & Pan Gasket 1990-98	1	

PART #	TECHNICAL MANUALS	QTY.	REFERENCE #
38400	Technical Manual, F4E Mazda/Ford 1990-Up	1	F4EAT

PART #	ELECTRICAL COMPONENTS	QTY.	REFERENCE #
38410A	Switch, F4E Neutral (With Connector On End Of Wire Harness) 1991-96	1	
38410AA	Neutral Switch, F4E (With Connector Made On Switch & Points Out To Side Of The Transmission) (Has No Wires On Switch) 1997-02	1	
38410AB	Neutral Switch, F4E (With Connector Made On Switch & Points Up) (No Wire Harness) 1997-Up	1	
38410AC	Neutral Switch, F4E (With Connector Made On Switch & Points To The Rear Of The Transmission) (No Wire Harness) 1997-Up	1	
38417A	Pulse Generator, F4E	1	
38420A	Solenoid Set, F4E (For 4 Solenoid Valve Body) 1991-Up	1	
38421A	Solenoid, F4E 1-2 Shift (Green Connector) 1990-Up (Has A Long Bent Bracket)	1	35678121
38422A	Solenoid, F4E 2-3 & 3-4 Shift	1	35678122
38425A	Solenoid, F4E TCC (Lock-Up) (Beige Connector) 1990-Up (Has A Short Straight Bracket)	1	
38431A	Solenoid, F4E EPC 1998-Up (For Valve Body With 5 Solenoids) Solenoid Is .940"OD (All Except Kia)	1	
38431B	Solenoid, F4E EPC 1998-Up (For Valve Body With 5 Solenoids) Solenoid Is .800"OD	1	
38446A	Wire Harness, F4E Internal (6 Pin Case Connector With 2 Two Wire & 2 One Wire Connectors) 1990-Up	1	
38446AA	Wire Harness, F4E Internal (7 Pin Case Connector With 2 Two Wire & 3 One Wire Connectors) 1990-Up	1	

MAZDA

FWD 4 Speed (1 Pan)



F4EAT / F4A-EL / F4E

PART #	MISC. COMPONENTS	QTY.	REFERENCE #
38475A	Sleeve, F4E Turbine Shaft (Teflon)	1	

PART #	HARD PARTS	QTY.	REFERENCE #
38500A	Pump, F4E Complete (With 4 Lube Holes Between Rings)	1	
38500B	Pump, F4E Complete (With 6 Lube Holes Between Rings)	1	

PART #	PUMP COMPONENTS	QTY.	REFERENCE #
S38507PK	Pump Discharge Valve Kit, F4E With Springs (Sonnax) (Increases Pump Flow To Pressure Regulator)	1	K74878

PART #	HARD PARTS (Continued)	QTY.	REFERENCE #
38510A	Pump Body W/Gears, F4E (With 3 Lube Holes Between Bolts)	1	
38510B	Pump Body W/Gears, F4E (With 4 Lube Holes Between Bolts)	1	
38520A	Stator, F4E (With 4 Lube Holes Between Rings)	1	
38520B	Stator, F4E (With 6 Lube Holes Between Rings)	1	
38529A	Converter Reactor, F4E (31 Splines)	1	
38550A	Drum, F4E 3-4 Clutch (Stamped Steel) With 38 Holes Outside	1	
38550B	Drum, F4E 3-4 Clutch (Stamped Steel) With 57 Holes Outside	1	
38550C	Drum, F4E 3-4 Clutch (Smooth Outside) With 57 Holes Outside	1	
38556A	Drum, F4E Reverse & Forward Clutch	1	
38558A	Drum, F4E (Band Drum) With Sun Gear	1	43678261
38559A	Drum, F4E Coast Clutch	1	
38560A	Piston Kit, F4E 3-4 Clutch (.458" Thick Piston)	1	
38560B	Piston Kit, F4E 3-4 Clutch (.382" Thick Piston)	1	
38566A	Piston Kit, F4E Reverse Clutch	1	
38567A	Piston Kit, F4E Low/Reverse Clutch	1	
38569A	Piston Kit, F4E Coast Clutch	1	
38574A	Clutch Hub, F4E Forward Clutch (Less Sprag)	1	
38577A	Clutch Hub & Inner Race, F4E Low/Reverse Clutch (34 Teeth Hub)	1	F1CZ-7A089-A
38579A	Clutch Hub, F4E Coast Clutch (With Inner Race)	1	
38584A	Planet, F4E (34 Teeth On Flange) With .275" Tall Step In Center Of Flange (Inside Where #245 Washer Sets)	1	
38584B	Planet, F4E (34 Teeth On Flange) No Raised Step In Center Of Flange (Inside Where #245 Washer Sets)	1	
38594A	Ring Gear, F4E Planet (10 Lugs, 5 1/8" OD)	1	
38614A	Sun Gear, F4E (2 13/16" Long)	1	
38626A	Shell, F4E Output With 19 Lug Park Gear	1	F3CZ-7F283-A
38626AA	Shell, F4E Output With 12 Lug Park Gear	1	

PART #	SPRAGS & ONE WAY CLUTCHES	QTY.	REFERENCE #
38642A	Sprag, F4E Low/Reverse With Outer Race (.590" Wide)	1	F1CZ-7B456-A
38642AA	Sprag, F4E Low/Reverse With Outer Race (.605" Wide)	1	
38648A	Sprag Assembly, F4E Forward With Inner & Outer Race	1	
38658A	Sprag, F4E Forward	1	F1CZ-7A089-B

PART #	HARD PARTS (Continued)	QTY.	REFERENCE #
38671A	Pump Shaft, F4E Drive (13 9/16" Long)	1	
38673A	Turbine Shaft, F4E (11 3/8" Long)	1	
38679A	Shaft, F4E Idler Gear	1	
38714AK	Idler Gear, F4E With Bearings (39 Teeth) 1 3/16" Thick (3 Groove)	1	
38714BK	Idler Gear, F4E With Bearings (40 Teeth) 1 Groove	1	
38714CK	Idler Gear, F4E With Bearings (38 Teeth) 1.150" Thick (4 Grooves)	1	
38714DK	Idler Gear, F4E With Bearings (41 Teeth)	1	
38715A	Differential Assembly, F4E With Ring Gear (71 Teeth) 3 Groove (Fits 38714AK & 38730B)	1	
38715AA	Differential Assembly, F4E With Ring Gear (71 Teeth) 1 Groove (Fits 38715BK & 38730A)	1	
38715AB	Differential Assembly, F4E With Ring Gear (71 Teeth) 4 Groove	1	
38715B	Differential Assembly, F4E With Ring Gear (70 Teeth) 1 Groove	1	
38715C	Differential Assembly, F4E With Ring Gear (69 Teeth) 1 Groove	1	
38715CA	Differential Assembly, F4E With Ring Gear (69 Teeth) 2 Groove	1	
38715CC	Differential Assembly, F4E With Ring Gear (69 Teeth) 1 Wide Groove On Bearing Side	1	
38715CD	Differential Assembly, F4W With Ring Gear (69 Teeth) 1 Narrow Groove On Bearing Side (Fits 38714DK & 38730D)	1	
38715CE	Differential Assembly, F4E With Ring Gear (69 Teeth) 1 Wide Groove On Housing Side	1	

MAZDA

# F4EAT / F4A-EL / F4E



FWD 4 Speed (1 Pan)

PART #	HARD PARTS (Continued)	QTY.	REFERENCE #
38715D	Differential Assembly, F4E With Ring Gear (73 Teeth) 3 Groove	1	
38715DA	Differential Assembly, F4E With Ring Gear (73 Teeth) 4 Groove (Fits 38714CK & 38730C)	1	
38715E	Differential Assembly, F4W With Ring Gear (78 Teeth)	1	
38730A	Pinion, F4E Output Gear With Bearings (19 Teeth) 33 Splines (1 Groove)	1	
38730B	Pinion, F4E Output Gear With Bearings (20 Teeth) 33 Splines (3 Groove)	1	
38730C	Pinion, F4E Output Gear With Bearings (21 Teeth) 33 Splines (4 Groove)	1	
38730D	Pinion, F4E Output Gear With Bearings (17 Teeth) 33 Splines (1 Groove)	1	
38730E	Pinion, F4E Output Gear With Bearings (18 Teeth) 33 Splines (1 Groove)	1	
38730EA	Pinion, F4E Output Gear With Bearings (18 Teeth) (2 Wide Grooves)	1	
38735A	Cover, F4E Idler Gear	1	
38740A	Valve Body, F4E (4 Solenoid) 1.8L (No Tube)	1	F1CZ-7A100-A
38740AA	Valve Body, F4E (4 Solenoid) (With 1 Tube) (Has The 2-3 Timing Valve By Itself & No 3-2 Timing Valve)	1	
38740B	Valve Body, F4E (4 Solenoid) 1.9L & 2.0L (With 1 Tube)(Has A 2-3 & 3-2 Timing Valve)	1	F1CZ-7A100-B
38740BD	Valve Body, F4E (5 Solenoid) (With 1 Tube)(Has The 2-3 Timing Valve By Itself & No 3-2 Timing Valve)	1	
38740C	Valve Body, F4E (5 Solenoid) With 1 Tube (Has The 2-3 Timing Valve & The 3-2 Timing Valve Side By Side)	1	
38740CA	Valve Body, F4E (5 Solenoid) No Tube	1	

PART #	VALVE BODY COMPONENTS	QTY.	REFERENCE #
S38741BAK	Boost Valve Kit, F4E (Valve, Sleeve & End Plug)(Sonnax)(For Units With Electronic Transmission)	1	74846-01K
S38741DA	Valve, F4E Pressure Modulator (Oversize) (Sonnax) (Use W/Tool # T-74846-TL4)	1	74846-04
T-74846-TL4	Reamer & Jig, F4E (For S38741DA) (Sonnax)	1	74846-TL4
S38741PA	Valve, F4E Pressure Regulator (Oversize) Sonnax (Use W/Tool # T-74846-TL5)	1	74846-05
T-74846-TL5	Reamer & Jig, F4E (For S38741PA) (Sonnax)	1	74846-TL5

MAZDA

PART #	HARD PARTS (Continued)	QTY.	REFERENCE #
38750	Bell Housing, F4E (Top Bolts 5 1/8") No Crank Sensor Hole (Cast # FB03)	1	
38750A	Bell Housing, F4E (Top Bolts 5 1/8") No Crank Sensor Hole (Cast # FU65)	1	
38750AA	Bell Housing, F4E (Top Bolts 5 1/8") With Crank Sensor Hole	1	
38750B	Bell Housing, F4E (Top Bolts 6 1/4") No Crank Sensor Hole (Cast #FU60)	1	
38750BA	Bell Housing, F4E (Top Bolts 6 1/4") With Crank Sensor Hole (Cast # FW01)	1	
38750BB	Bell Housing, F4E (Top Bolts 6 1/4") No Crank Sensor Hole (Cast #FW30)	1	
38750BC	Bell Housing, F4E (Top Bolts 6 1/4") With Crank Sensor Hole (Cast # K2A2)	1	
38750C	Bell Housing, F4E (Top Bolts 2 1/8") Cast # FW12	1	
38750D	Bell Housing, F4E (Top Bolts 4 7/8") With Crank Sensor Hole (Cast # K25R)	1	
38760A	Case, F4E (13 Bolts To Bell) Uses Throttle Cable (3 Threaded Bosses On Top For Wire Harness, 2 Are 6mm And 1 Is 12mm)	1	
38760AA	Case, F4E (13 Bolts To Bell) Uses A Throttle Cable (3 Threaded Bosses On Top For Wire Harness, All 3 Are 6mm)	1	
38760AB	Case, F4E (13 Bolts To Bell) Uses A Throttle Cable (2 Threaded Bosses On Top For Wire Harness, Both Are 6mm) There Is Also A Boss With A 12mm Hole That Is Not Threaded	1	
38760B	Case, F4E (13 Bolts To Bell) No Throttle Cable (Cast # KIA) With 4 Threaded Mounting Bosses	1	
38760BA	Case, F4E (13 Bolts To Bell) No Throttle Cable With 3 Threaded Mounting Bosses	1	
38765A	Pan, F4E (Bottom) (1 5/8" At Deepest Point)	1	
38765AA	Pan, F4E (Bottom) (2 1/2" At Deepest Point)	1	
38774A	Speed-O Housing, F4E (With 22 Teeth Gear & 2 Prong Connector) (Cast # F7C6-17271-AB) Aluminum Housing With Plastic Connector	1	
38774AA	Speed-O Housing, F4E (With 22 Teeth Gear & 2 Prong Rectangle Connector) (Cast # TR0100) All Plastic	1	
38774B	Speed-O Housing, F4E (With 23 Teeth Gear & 2 Prong Connector) (Cast # FOC6-17271-AB) Aluminum Housing With Plastic Connector	1	
38776AK	Bolt Set, F4E Bell Housing To Case	1	
38777AK	Bolt Set, F4E Pump To Case	1	
38782AK	Bolt Set, F4E Valve Body To Case	1	
38799A	Nut, F4E Idler Gear	1	
28847A	Gear, F4E Speed-O Drive (25 Teeth) On Differential	1	
28848AK	Gear & Housing, F4E Speed-O Driven (20 Teeth)	1	
38853A	Cushion, F4E Forward Clutch	1	
38854A	Retainer, F4E Reverse Clutch Spring	1	
38856A	Cushion, F4E Coast Clutch	1	
38857A	Waved Ring, F4E Low/Reverse Clutch (Solid Ring) 1990-97	1	
38857B	Waved Ring, F4E Low/Reverse Clutch (Split, Not Solid) 1997-Up	1	
38862A	Snap Ring, F4E Holds 3-4 Clutch Retainer In Drum	1	

38865A	..... Snap Ring, F4E Holds Low/Reverse Clutch Retainer In Case .....	1	.....
38870A	..... Snap Ring, F4E Holds Low/Reverse Sprag In Case.....	1	.....
38876A	..... Snap Ring, F4E Holds Forward Pressure Plate In Drum.....	1	.....
38878A	..... Snap Ring, F4E Holds Coast Clutch Pressure Plate In Case .....	1	.....
38879A	..... Snap Ring, F4E Holds Coast Clutch Retainer In Drum.....	1	.....
38880A	..... Snap Ring, F4E Sun Gear To Inner Race (Rear).....	1	.....
38881A	..... Snap Ring, F4E Sun Gear To Inner Race (Front).....	1	.....
38882A	..... Snap Ring, F4E Planet To Low/Reverse Sprag Inner Race.....	1	.....
38889A	..... Snap Ring, F4E Holds Ring Gear In Output Shell .....	1	.....
38890A	..... Snap Ring, F4E Holds 3-4 Clutch Pressure Plate In Drum .....	1	.....
38891A	..... Snap Ring, F4E Holds Low/Reverse Pressure Plate In Case.....	1	.....
38892A	..... Snap Ring, F4E Holds Reverse Pressure Plate In Drum .....	1	.....
38893A	..... Snap Ring, F4E Holds Reverse Clutch Retainer In Drum.....	1	.....
38895A	..... Snap Ring, F4E Holds Turbine Shaft To Reverse Drum .....	1	.....
38896A	..... Snap Ring, F4E Holds Servo Cover In Case .....	1	.....
38900A	..... Servo Assembly, F4E 2-4 Band (1.566"OD).....	1	.....
38900B	..... Servo Assembly, F4E 2-4 Band (2.314"OD).....	1	.....
38900C	..... Servo Assembly, F4E 2-4 Band (1.410"OD).....	1	.....
28901	..... Spring, F4E Servo (3 Per Pack) 1.654" Long.....	1	.....
28901A	..... Spring, F4A Servo (3 Per Pack) 1.703" Long		
38901AA	..... Spring, F4E Servo (3 Per Pack) (Corrects Rough 1-2 & 3-4 Upshift / Helps Prevent ..... Rough 2-3) .....	1	.....
38902A	..... Piston, F4E 2-4 Servo .....	1	.....
38904A	..... Cover, F4E 2-4 Servo.....	1	.....
38904B	..... Cover, F4E 2-4 Servo (2.314"ID) .....	1	.....
38904C	..... Cover, F4E 2-4 Servo (1.410"ID) .....	1	.....
38915A	..... Strut Assembly, F4E 2-4 Band .....	1	.....
38925A	..... Accumulator Assembly, F4E 1-2 With 1 Spring.....	1	.....
38925AA	..... Accumulator Assembly, F4E 1-2 With 2 Springs (1.9L Only) .....	1	.....
38930A	..... Accumulator Assembly, F4E 2-3 .....	1	.....
38945A	..... Accumulator, F4E Neutral-Reverse.....	1	.....
38950A	..... Accumulator Assembly, F4E Neutral-Overdrive .....	1	.....
38960A	..... Piston, F4E 3-4 Clutch .....	1	.....
38966A	..... Piston, F4E Reverse Clutch .....	1	.....
38967A	..... Piston, F4E Low/Reverse Clutch .....	1	.....
38969A	..... Piston, F4E Coast Clutch .....	1	.....
38970A	..... Spring, F4E 3-4 Clutch Return .....	1	..... 36678441
38976A	..... Spring, F4E Reverse Beveled Return .....	1	.....
38977A	..... Retainer W/Spring, F4E Low/Reverse Clutch .....	1	.....
38979A	..... Retainer W/Spring, F4E Coast Clutch.....	1	.....
38980A	..... Retainer, F4E 3-4 Clutch Spring .....	1	.....
38991A	..... Linkage Assembly, F4E Internal.....	1	.....
38995A	..... Park Pawl Assembly, F4E .....	1	.....
38996A	..... Fitting, F4E Cooler Line .....	1	.....
38999A	..... Tube, F4E Oil .....	1	.....