

Aluminum Case Powerglide

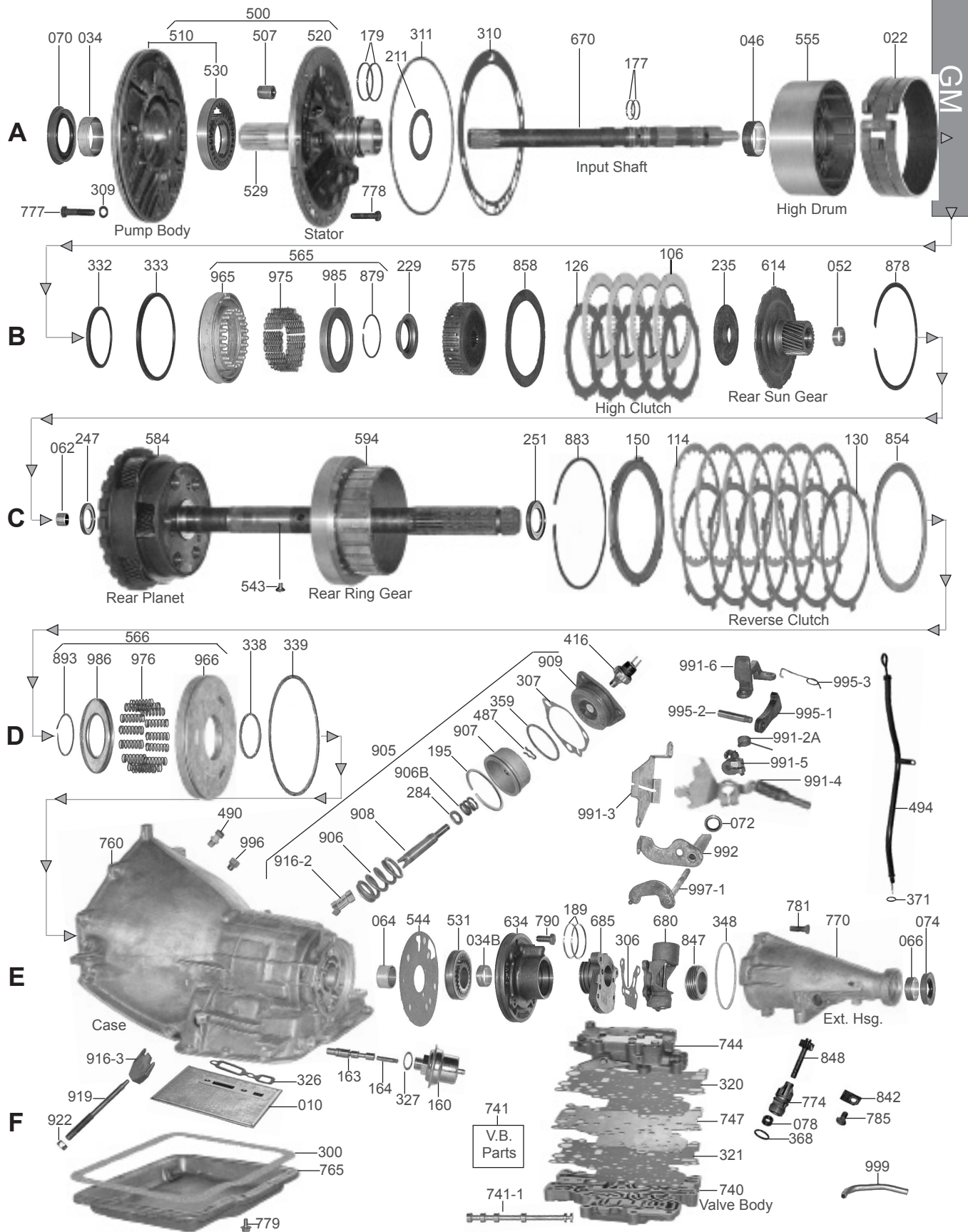

RWD 2 Speed



PART #	PAPER & RUBBER KIT	QTY.	REFERENCE #
103000.....	Paper & Rubber Kit, Aluminum Powerglide 1962-73	1	
PART #	OVERHAUL KITS	QTY.	REFERENCE #
103002.....	Overhaul Kit, Aluminum Powerglide 1962-73.....	1	
103002R.....	Overhaul Kit, Aluminum Powerglide (Racing) 1962-73 (With Teflon Rings)(No Valve Body Gaskets).....	1	
PART #	MASTER L/STEEL KIT	QTY.	REFERENCE #
103004.....	Master L/Steels Kit, Aluminum Powerglide 1962-73	1	
103004RHP	Master L/Steels Kit, Aluminum Powerglide (Hi-Performance Indy Reds) 1962-73	1	
103004RS1.....	Master L/Steels Kit, Aluminum Powerglide (Stage 1) 1962-73 (No Valve Body Gaskets)	1	
PART #	MASTER W/STEEL KIT	QTY.	REFERENCE #
103006.....	Master W/Steels Kit, Aluminum Powerglide 1962-73.....	1	
PART #	FILTER	QTY.	REFERENCE #
103010.....	Filter, Aluminum Powerglide 1962-73.....	1	6263005
103010A	Filter, Aluminum Powerglide (Larger, Square For Racing) 1962-73.....	1	
PART #	FILTER KIT	QTY.	REFERENCE #
103011A.....	Filter Kit, Aluminum Powerglide (Large, Square) 1962-73.....	1	
PART #	BANDS	QTY.	REFERENCE #
105022.....	Band, Aluminum Powerglide (1 7/8" Wide) 1962-73	1	
105022B.....	Band, Aluminum Powerglide (Hi-Performance) 1962-73	1	
105022H.....	Band, Aluminum Powerglide (Hi-Performance) Red Lining (1 7/8" Wide).....	1	
S105022HA	Band, Aluminum Powerglide (Hi-Performance, Race Only) (Sonnax) 1962-73	1	
105022HB.....	Band, Aluminum Powerglide (Hi-Performance) Racing (2 1/4" Wide).....	1	
PART #	BUSHINGS	QTY.	REFERENCE #
103030.....	Bushing Kit, Aluminum Powerglide 1962-73	1	
44034.....	Bushing, Aluminum Powerglide Front Pump Body 1962-73	1	8623940
103034B	Bushing, Aluminum Powerglide Governor Support Or Rear Pump 1962-73.....	1	3789877
103046.....	Bushing, Aluminum Powerglide High Clutch Drum (Babbitt) 1962-73 (Can Use 54046A).....	1	3840760
54046A.....	Bushing, Aluminum Powerglide High Clutch Drum (Bronze) 1962-73	1	
S103046A.....	Bushing, Aluminum Powerglide High Clutch Drum (Finish In Place) (Sonnax) 1962-73	1	
103052.....	Bushing, Aluminum Powerglide Sun Gear (W/Splines Inside) (Brass) 1962-73	1	
44062.....	Bushing, Aluminum Powerglide Output Shaft (Pilot) 1962-73.....	1	3789034
103064.....	Bushing, Aluminum Powerglide Case 1962-73	1	3789009
44066.....	Bushing, Aluminum Powerglide Extension Housing (1.500"ID)(Babbitt) 1962-73.....	1	6260048
44066B.....	Bushing, Aluminum Powerglide Extension Housing (1.500"ID)(Bronze) 1962-73	1	
PART #	METAL CLAD SEALS	QTY.	REFERENCE #
44070.....	Seal, Aluminum Powerglide Front 1962-73.....	1	8670283
103072.....	Seal, Aluminum Powerglide Linkage 1962-73.....	1	3789137
44074.....	Seal, Aluminum Powerglide Rear (W/Flange, W/Out Boot) 1962-73	1	1243402
44074C.....	Seal, Aluminum Powerglide Rear (W/Flange, W/ Short Boot) 1962-73	1	
44078X.....	Seal, Aluminum Powerglide Speed-O Shaft.....	1	1240382
PART #	FRICTION CLUTCH	QTY.	REFERENCE #
103106.....	Friction, Aluminum Powerglide High Clutch (.098") 1962-73	4	3779904
103106AHP	Friction, Aluminum Powerglide High Clutch (.062") Hi-Performance 1962-73	AR.....	
103106AHPK..	Friction Kit, Aluminum Powerglide High Clutch (.060") Hi-Performance (8 Per Kit)		
.....	1962-73 (Alto)	1	
103106APPK..	Friction & Steel Kit, Aluminum Powerglide High Clutch (.060") Hi-Performance (9 Frictions & 9 Kolene Steels) 1962-73 (Alto).....	1	
103106AS.....	Friction, Aluminum Powerglide High Clutch (.060") (Stage 1) 1962-73.....	4	
103106HD	Friction, Aluminum Powerglide High Clutch (.098") Heavy Duty	4	
103106HP.....	Friction, Aluminum Powerglide High Clutch (.098") Hi-Performance 1962-73	4	

Aluminum Case Powerglide



RWD 2 Speed

GM

PART #	FRICITION CLUTCH	QTY.	REFERENCE #
103106HPK	Friction Kit, Aluminum Powerglide High Clutch (.098") Hi-Performance (5 Per Kit) 1962-73 (Alto)	1	
103106S1	Friction, Aluminum Powerglide High Clutch (.098") (Stage 1) 1962-73	4	
44114	Friction, Aluminum Powerglide Reverse Clutch (.098") 1962-73	5	8641512
44114HP	Friction, Aluminum Powerglide Reverse Clutch (.098") (Hi-Performance) 1962-73	5	
44114HPK	Friction, Aluminum Powerglide Reverse Clutch (.098") (Hi-Performance) (5 Per Kit) 1962-73	1	
44114S1	Friction, Aluminum Powerglide Low/Reverse Clutch (.098") (Stage 1) 1962-73	5	
103119	Friction Module, Aluminum Powerglide 1962-73	1	
103119HP	Friction Module, Aluminum Powerglide (Hi- Performance) (Indy Reds) 1962-73	1	
103119S1	Friction Module, Aluminum Powerglide (Stage 1) 1962-73	1	

PART #	STEEL CLUTCH	QTY.	REFERENCE #
103126	Steel, Aluminum Powerglide High Clutch (.070") 1962-73	3-5	1366440
103126B	Steel, Aluminum Powerglide High Clutch (.070") (Kolene) 1962-73	3-5	
103126BK	Steel Kit, Aluminum Powerglide High Clutch (.070") (Kolene) (5 Per Kit) 1962-73	3-5	
103126BA	Steel, Aluminum Powerglide High Clutch (.070") (Kolene With Holes) 1962-73	3-5	
103126BBHP	Steel, Aluminum Powerglide High Clutch (.060") (Kolene With Holes) 1962-73	3-5	
103126BHPK	Steel Kit, Aluminum Powerglide High Clutch (.060") (Kolene) (8 Per Kit) 1962-73	1	
103130	Steel, Aluminum Powerglide Reverse Clutch (.070") 1962-73	4-6	3799210
103130B	Steel, Aluminum Powerglide Reverse Clutch (.070") (Kolene) 1962-73	4-6	
103139	Steel Module, Aluminum Powerglide 1962-73	1	

PART #	CLUTCH PRESSURE PLATES	QTY.	REFERENCE #
103150	Pressure Plate, Aluminum Powerglide Reverse Clutch 1962-73	1	

PART #	MODULATORS	QTY.	REFERENCE #
103160	Modulator, Aluminum Powerglide (Adjustable) 1962-73	1	5638205
103160-3	Spring, Aluminum Powerglide Between Modulator & Valve	1	
S103160-6K	Plug Kit, Aluminum Powerglide Modulator Plug & Gasket (Sonnax)	1	
103163	Valve, Aluminum Powerglide (Under Modulator Pin) 1962-73	1	
103164	Pin, Aluminum Powerglide (Under Modulator) 1962-73	1	

PART #	VALVE BODY KITS	QTY.	REFERENCE #
T103171	Reprogramming Kit, Aluminum Powerglide (Full Race) (Automatic Or Manual Shift) (Transgo)	1	PG-2S

PART #	OIL SEALING RINGS	QTY.	REFERENCE #
103175	Ring Kit, Aluminum Powerglide 1962-73	1	
103175T	Ring Kit, Aluminum Powerglide 1962-73 (Teflon)	1	
103175BT	Ring Kit, Aluminum Powerglide (Oversized) Teflon	1	
103177	Ring, Aluminum Powerglide Input Shaft 1962-73	2	3817715
103179	Ring, Aluminum Powerglide HI-Clutch 1962-73 (Also Fits Governor Support)	4	3689808
103189	Ring, Aluminum Powerglide Governor Support 1962-73 (Use 103179)	2	
103195	Ring, Aluminum Powerglide Low Servo	1	3789084

PART #	WASHERS & BEARINGS	QTY.	REFERENCE #
S103211	Washer, Aluminum Powerglide Stator To High Drum (.061") 1962-73 (Sonnax)	1	
103211A	Washer, Aluminum Powerglide Stator To High Drum (.078") 1962-73	1	
S103211A	Washer, Aluminum Powerglide Stator To High Drum (.078") 1962-73 (Sonnax)	1	
103211B	Washer, Aluminum Powerglide Stator To High Drum (.092") 1962-73	1	
103211C	Washer, Aluminum Powerglide Stator To High Drum (.106") 1962-73	1	
103229	Cup Race, Aluminum Powerglide High Clutch Drum To Hub 1962-73	1	
103235	Washer, Aluminum Powerglide High Clutch Hub To Rear Sun Gear 1962-73	1	
103247	Washer, Aluminum Powerglide Sun Gear To Planet (Bronze) 1962-73	1	
S103247	Washer, Aluminum Powerglide Sun Gear To Planet (Bronze) 1962-73 (Sonnax)	1	
103247A	Bearing, Aluminum Powerglide Sun Gear To Planet 1962-73	1	
S103247A	Bearing, Aluminum Powerglide Sun Gear To Planet 1962-73 (Sonnax)	1	
103251	Bearing, Aluminum Powerglide Planet To Case 1962-73	1	
S103251	Bearing, Aluminum Powerglide Planet To Case 1962-73 (Sonnax)	1	
103284	Washer, Aluminum Powerglide Servo 1962-73	1	

PART #	GASKETS & RUBBER COMPONENTS	QTY.	REFERENCE #
103300.....	Gasket, Aluminum Powerglide Pan 1962-73.....	1	3789148
103306.....	Gasket, Aluminum Powerglide Governor Cover.....	1	
103307.....	Gasket, Aluminum Powerglide Low Servo.....	1	3789086
44309.....	Gasket, Aluminum Powerglide Pump Bolt.....	7	
103310.....	Gasket, Aluminum Powerglide Front Pump.....	1	3789022
103311.....	O-Ring, Aluminum Powerglide Front Pump.....	1	
103326.....	Gasket, Aluminum Powerglide Filter.....	1	3795990
103327.....	Gasket, Aluminum Powerglide Modulator.....	1	6257218
103332.....	Lip Seal, Aluminum Powerglide High Drum (Inner) (3.06"OD).....	1	
103332A.....	Lip Seal, Aluminum Powerglide High Drum (Inner) (2.50"OD) 1962 Only.....	1	
103333.....	Lip Seal, Aluminum Powerglide High Drum (Outer).....	1	
44338.....	Lip Seal, Aluminum Powerglide Reverse Piston (Inner).....	1	
44339.....	Lip Seal, Aluminum Powerglide Reverse Piston (Outer).....	1	
103348.....	O-Ring, Aluminum Powerglide Extension Housing To Case.....	1	
103359.....	O-Ring, Aluminum Powerglide Low Servo.....	1	
S103359.....	O-Ring, Aluminum Powerglide Servo (Viton) (Sonnax).....	1	
S103359A.....	O-Ring, Aluminum Powerglide Servo (Teflon) (Sonnax).....	1	
103368.....	O-Ring, Aluminum Powerglide Speed-O Sleeve (Inner).....	2	10054241
44371A.....	O-Ring, Aluminum Powerglide Filler Tube.....	1	6264902

PART #	ELECTRICAL COMPONENTS	QTY.	REFERENCE #
44416Y.....	Switch, Aluminum Powerglide Spark Control (3 Prong).....	1	3996287

PART #	HARD PARTS	QTY.	REFERENCE #
103500.....	Pump, Aluminum Powerglide (Complete).....	1	
103510.....	Pump Body, Aluminum Powerglide (With Gears).....	1	
103520.....	Stator, Aluminum Powerglide (Pump Cover).....	1	
103529.....	Stator Tube, Aluminum Powerglide.....	1	
103530.....	Pump Gear Set, Aluminum Powerglide Front Pump.....	1	
103530X.....	Pump Gear Set, Aluminum Powerglide (.560" Thick)(.030"OD)(Oversized).....	1	
103531.....	Pump Gear Set, Aluminum Powerglide Rear Pump.....	1	
103543.....	Flange Pin, Aluminum Powerglide Rear Pump Drive Gear Flange Pin.....	1	
103544.....	Plate, Aluminum Powerglide Rear Pump.....	1	
103555.....	Drum, Aluminum Powerglide High Clutch (4 Or 5 Clutch).....	1	
S103555B.....	Drum, Aluminum Powerglide High Clutch (10 Clutch)(High Performance)(Sonnax).....	1	
S103555BK.....	Drum Kit, Aluminum Powerglide High Clutch (10 Clutch)(Complete With Clutch)(High Performance) (Sonnax).....	1	
S103555BA.....	Drum W/Bearing, Aluminum Powerglide High Clutch (10 Clutch)(High Performance)(Sonnax).....	1	
S103555BAK.....	Drum Kit W/Bearing, Aluminum Powerglide High Clutch (10 Clutch)(Complete With Clutch)(High Performance)(Sonnax).....	1	
103565.....	Piston Kit, Aluminum Powerglide High Clutch (4 Clutch).....	1	
103565A.....	Piston Kit, Aluminum Powerglide High Clutch (5 Clutch).....	1	
103566.....	Piston Kit, Aluminum Powerglide Reverse Clutch (0.875" Thick Piston).....	1	
103566A.....	Piston Kit, Aluminum Powerglide Reverse Clutch (1.075" Thick Piston).....	1	
103566B.....	Piston Kit, Aluminum Powerglide Reverse Clutch (.815" Thick Piston).....	1	
103566C.....	Piston Kit, Aluminum Powerglide Reverse Clutch (.630" Thick Piston).....	1	
103575.....	Hub, Aluminum Powerglide High Clutch (4 Clutch) (15/16" Tall).....	1	
S103575A.....	Hub, Aluminum Powerglide High Clutch (5 Clutch) Carbon Steel (Sonnax) (Light Weight With Holes For Drag Racing).....	1	
S103575AA.....	Hub, Aluminum Powerglide High Clutch (5 Clutch) Carbon Steel (Sonnax) (No Holes For Drag Racing).....	1	
S103575B.....	Hub, Aluminum Powerglide High Clutch (10 Clutch)(Carbon Steel)(Sonnax)(Light Weight With Holes For Drag Racing).....	1	
103584AK.....	Planet Kit, Aluminum Powerglide (1.82 Ratio) 23 Teeth Sun Gear (Contains: Sun Gear, Ring Gear & Planet).....	1	
103584BK.....	Planet Kit, Aluminum Powerglide (1.76 Ratio) 26 Teeth Sun Gear (Contains: Sun Gear, Ring Gear & Planet).....	1	

PART #	PLANETARY COMPONENTS	QTY	REFERENCE #
S103584A-1.....	Washer, Aluminum Powerglide (1.82 Planet Pinion) Front (Sonnax).....	3	8415A
S103584A-1K.....	Washer Kit, Aluminum Powerglide (1.82 Planet Pinion) Front (Sonnax).....	1	8415AK
S103584A-2K.....	Planet Gear Set, Aluminum Powerglide (1.80 Ratio, Straight Cut Gears)(Contains: Planet Gears, Sun Gear & Ring Gear)(Sonnax) (Only Fits The 1.76 Ratio Housing).....	1	
S103584A-4K.....	Needle Bearing Kit, Aluminum Powerglide (1.82 Planet Pinion) (Sonnax).....	1	8413
S103584B-1.....	Washer, Aluminum Powerglide (1.76 Planet Pinion) Front (Sonnax).....	3	8415

Aluminum Case Powerglide



RWD 2 Speed

GM

PART #	PLANETARY COMPONENTS (Continued)	QTY	REFERENCE #
S103584B-1K	Washer Kit, Aluminum Powerglide (1.76 Planet) Front (Sonnax)	1	8415BK
S103584B-3K	Pin Kit, Aluminum Powerglide (1.76 Planet) Contains: Pins, Washers, Bolts (6 Each)(Sonnax)	1	28435K
S103584B-4K	Needle Bearing Kit, Aluminum Powerglide (1.76 Planet Pinion) (Sonnax)	1	28423
S103584B-7K	Planet Rebuild Kit, Aluminum Powerglide (1.76 Ratio)(Contains: Pins, Needles, Washers, Spacers & Bolts)(Sonnax)	1	
S103584B-8K	Spacer Kit, Aluminum Powerglide Pinion Bearing Spacers (3 Thick & 12 Thin Spacers)(Sonnax)	1	K28414
S103584BA-1	Washer, Aluminum Powerglide (1.76 Planet Pinion) Rear (Sonnax)	6	8415B

PART #	HARD PARTS (Continued)	QTY.	REFERENCE #
103594A	Ring Gear, Aluminum Powerglide Rear (1.82 Ratio)	1	
103594B	Ring Gear, Aluminum Powerglide Rear (1.76 Ratio)	1	
103614A	Sun Gear W/Hub, Aluminum Powerglide Rear (23 Teeth) (1.82 Ratio)	1	
103614B	Sun Gear W/Hub, Aluminum Powerglide Rear (26 Teeth) (1.76 Ratio)	1	
103634	Rear Pump/Support, Aluminum Powerglide (With Gears) 1962-66	1	
103634A	Support, Aluminum Powerglide Output Shaft (5"OD) Cast Iron	1	
103670	Shaft, Aluminum Powerglide Input (12 5/8" Long)	1	
103670A	Shaft, Aluminum Powerglide Input (12 7/8" Long)	1	
S103670C	Shaft, Aluminum Powerglide Input (30 Teeth Turbo Splines)(Sonnax)	1	
103680	Governor, Aluminum Powerglide	1	
103685A	Support, Aluminum Powerglide Governor	1	
103740	Valve Body, Aluminum Powerglide (Has Round Hole In Top Plate)	1	
103740A	Valve Body, Aluminum Powerglide (Has Square Hole In Top Plate)	1	
103741-1	Valve, Aluminum Powerglide Manual	1	
S103741TK	Boost Valve & Sleeve Assembly, Aluminum Powerglide (Sonnax)	1	
103744	Auxillary Valve Body, Aluminum Powerglide	1	
103747	Plate, Aluminum Powerglide Valve Body	1	
103760B	Case, Aluminum Powerglide (Chevrolet Water Cooled) No Rear Pump	1	
103765	Pan, Aluminum Powerglide With Drain Plug On The Side	1	
103770A	Extension Housing, Aluminum Powerglide (9" Long)	1	
103770B	Extension Housing, Aluminum Powerglide (11 3/8" Long)	1	
44774	Speed-O-Housing, Aluminum Powerglide (7/8" Steel, Uses Metal Clad Seal)	1	
103774	Speed-O Housing, Aluminum Powerglide (No Seal Type)	1	
44774A	Speed-O-Housing, Aluminum Powerglide (7/8" Aluminum, Uses Rubber Seal)	1	
103777K	Bolt Set, Aluminum Powerglide Pump To Case (8 Pieces)	1	
103778K	Bolt Set, Aluminum Powerglide Stator To Pump Body	1	
103779K	Bolt Set, Aluminum Powerglide Rear Pump To Case & Pan To Case	1	
103781K	Bolt Set, Aluminum Powerglide Extension Housing To Case	1	
103782K	Bolt Set, Aluminum Powerglide Valve Body To Case (7 Pieces)	1	
103785	Bolt, Aluminum Powerglide Speed-o Sleeve Bracket	1	
103787	Bolt, Aluminum Powerglide Holds Governor Support To Output Shaft	1	
44793K	Bolt Set, Aluminum Powerglide Filter To Valve Body (2 Pieces)	1	
103842	Bracket, Aluminum Powerglide Speed-O Sleeve	1	
103847	Gear, Aluminum Powerglide Speed-O Drive	1	
103848	Gear, Aluminum Powerglide Speed-O Driven	1	
103854	Wave Plate, Aluminum Powerglide Reverse Clutch	1	
103878	Snap Ring, Aluminum Powerglide Holds Rear Sun Gear In High Drum	1	
103879	Snap Ring, Aluminum Powerglide High Clutch	1	
103883	Snap Ring, Aluminum Powerglide Reverse Clutch	1	
103893	Snap Ring, Aluminum Powerglide Reverse Piston	1	
103905	Servo Assembly, Aluminum Powerglide	1	
103906	Spring, Aluminum Powerglide Servo (Large)	1	
103906B	Spring, Aluminum Powerglide Servo (Small)	1	
103907	Piston, Aluminum Powerglide Servo	1	
S103907AHPK	Piston Kit, Aluminum Powerglide Servo (Hi-Performance) Dual Teflon Ring Piston, Rings & Gasket (Sonnax)	1	
S103907BHPK	Servo Assembly, Aluminum Powerglide (Hi-Performance) Dual Teflon Ring Piston, Rings, Gasket & Cover (Purple Anodized)(Sonnax)	1	
S103907CHPK	Servo Assembly, Aluminum Powerglide (Hi-Performance) Dual Teflon Ring Piston, Rings, Gasket & Cover (Non Anodized) (Sonnax)	1	
S103907HPK	Piston Kit, Aluminum Powerglide Servo (Hi-Performance) Dual Viton Ring Piston, Rings & Gasket (Sonnax)	1	
S103907JHPK	Servo Assembly, Aluminum Powerglide (Hi-Performance) Dual Viton Ring Piston, Rings, Gasket & Cover (Purple Anodized) (Sonnax)	1	
S103907LHPK	Servo Assembly, Aluminum Powerglide (Hi-Performance) Dual Viton Ring Piston, Rings, Gasket & Cover (Non-Anodized) (Sonnax)	1	

103908.....	Pin, Aluminum Powerglide Servo.....	1
103909.....	Cover, Aluminum Powerglide Servo.....	1
S103909K.....	Servo Cover Kit, Aluminum Powerglide (Cover, Gasket & O-Ring) (Sonnax).....	1
103916-2.....	Strut, Aluminum Powerglide Band (Servo Side).....	1
103916-3.....	Strut, Aluminum Powerglide Band (Adjustment Side) (Wedge).....	1
103919.....	Band Adjuster Screw, Aluminum Powerglide.....	1
103965.....	Piston, Aluminum Powerglide High Clutch.....	1
103966.....	Piston, Aluminum Powerglide Reverse Clutch (.875" Thick).....	1
103966A.....	Piston, Aluminum Powerglide Reverse Clutch (1.075" Thick).....	1
103966B.....	Piston, Aluminum Powerglide Reverse Clutch (.815" Thick).....	1
103966C.....	Piston, Aluminum Powerglide Reverse Clutch (.630" Thick).....	1
103966D.....	Piston, Aluminum Powerglide Reverse Clutch (.460" Thick)(Sonnax).....	1
103975.....	Spring Set, Aluminum Powerglide High Clutch Return (24 Springs).....	1
S103976K.....	Spring Kit, Aluminum Powerglide Reverse Clutch Return (17 Per Kit) (Sonnax).....	1
103976.....	Spring Set, Aluminum Powerglide Reverse Clutch Return (17 Springs).....	1
103985.....	Retainer, Aluminum Powerglide High Clutch.....	1
S103986.....	Retainer, Aluminum Powerglide Reverse Clutch Spring (Sonnax).....	1
103991-3.....	Bracket, Aluminum Powerglide Rooster Comb (Internal).....	1
103991-4.....	Rooster Comb, Aluminum Powerglide With Park Rod.....	1
103991-5.....	TV Linkage, Aluminum Powerglide (Internal).....	1
103991-6.....	Bracket, Aluminum Powerglide Rod (2 Bolt).....	1
S103992.....	Shift Lever, Aluminum Powerglide (Floor Shift) (Sonnax).....	1
34992.....	Shift Lever, Aluminum Powerglide External (Column Shift).....	1
S103992-1.....	Shift Lever, ALuminum Powerglide (Anti-Leak)(Sonnax).....	1
S103992A.....	Shift Lever, Aluminum Powerglide (Bolt Together 4 Hole) (Sonnax).....	1
103992B.....	Shift Lever, Aluminum Powerglide (Column Shift) (Welded).....	1
103995-1.....	Park Pawl, Aluminum Powerglide.....	1
103995-2.....	Pin, Aluminum Powerglide Park Pawl Pivot.....	1
103995-3.....	Spring, Aluminum Powerglide Park Pawl Return.....	1
103996.....	Fitting, Aluminum Powerglide Cooler Line.....	1
103997-1.....	TV Lever, Aluminum Powerglide (External) (Welded Type).....	1
103997A-1.....	TV Lever, Aluminum Powerglide (External) (Bolt Together Type) (2 Pieces).....	1
103999.....	Oil Tube, Aluminum Powerglide Valve Body To Case.....	1

Cast Iron Case Powerglide



RWD 2 Speed

PART #	PAPER & RUBBER KIT	QTY.	REFERENCE #
108000	Paper & Rubber Kit, Cast Iron Powerglide 1958-62	1	
108000C	Paper & Rubber Kit, Cast Iron Powerglide 1955-57	1	
108000E	Paper & Rubber Kit, Cast Iron Powerglide 1953-54	1	
108000G	Paper & Rubber Kit, Cast Iron Powerglide 1950-52	1	
PART #	OVERHAUL KITS	QTY.	REFERENCE #
108002	Overhaul Kit, Cast Iron Powerglide 1955-62	1	
108002C	Overhaul Kit, Cast Iron Powerglide 1955-57	1	
108002E	Overhaul Kit, Cast Iron Powerglide 1953-54	1	
108002G	Overhaul Kit, Cast Iron Powerglide 1950-52	1	
PART #	MASTER L/STEEL KIT	QTY.	REFERENCE #
108004	Master L/Steels Kit, Cast Iron Powerglide 1958-62	1	
108004C	Master L/Steels Kit, Cast Iron Powerglide 1955-57	1	
108004E	Master L/Steels Kit, Cast Iron Powerglide 1953-54	1	
108004G	Master L/Steels Kit, Cast Iron Powerglide 1950-52	1	
PART #	MASTER W/STEEL KIT	QTY.	REFERENCE #
108006	Master W/Steels Kit, Cast Iron Powerglide 1958-62	1	
108006C	Master W/Steels Kit, Cast Iron Powerglide 1955-57	1	
108006E	Master W/Steels Kit, Cast Iron Powerglide 1953-54	1	
108006G	Master W/Steels Kit, Cast Iron Powerglide 1950-52	1	
PART #	BANDS	QTY.	REFERENCE #
108022	Band, Cast Iron Powerglide Low & Reverse (Front & Rear) 1950-62	2	5459350
108022A	Band, Cast Iron Powerglide Low (Front, Some) (Double Wrap) 1955-62	1	3883918
PART #	BUSHINGS	QTY.	REFERENCE #
108030	Bushing Kit, Cast Iron Powerglide 1953-62	1	
44066	Bushing, Cast Iron Powerglide Extension Housing (1.500"ID)(Babbitt)	1	
44066B	Bushing, Cast Iron Powerglide Extension Housing (1.500"ID)(Bronze)	1	
PART #	METAL CLAD SEALS	QTY.	REFERENCE #
108070	Seal, Cast Iron Powerglide Front Pump 1950-52	1	
44070	Seal, Cast Iron Powerglide Front Pump 1953-63	1	
44074	Seal, Cast Iron Powerglide Extension Housing 1955-62	1	
PART #	FRICITION CLUTCH	QTY.	REFERENCE #
103106	Friction, Cast Iron Powerglide High Clutch .098" 1961-62	2-4	3779904
103106A	Friction, Cast Iron Powerglide High Clutch .060" 1961-62	2-4	3779904
108106	Friction, Cast Iron Powerglide High Clutch (Lug Type) 1950-55	4	3713694
108106A	Friction, Cast Iron Powerglide High Clutch (Flat) 1956-60	4	3748703
103106AHPK	Friction Kit, Cast Iron Powerglide High Clutch (.060") Hi-Performance (8 Per Kit) 1961-62	1	
103106APPK	Friction & Steel Kit, Cast Iron Powerglide High Clutch (.060") Hi-Performance (9 Frictions & 9- .060" Kolene Steels) 1961-62	1	
103106HP	Friction, Cast Iron Powerglide High Clutch (.098") Hi-Performance 1961-62	2-4	
103106HPK	Friction Kit, Cast Iron Powerglide High Clutch (.098") Hi-Performance (5 Per Kit) 1961-62	1	
103106S1	Friction, Cast Iron Powerglide High Clutch (.098"OD)(Stage 1) 1961-62	5	
108119	Friction Module, Cast Iron Powerglide 1955-62	1	
PART #	STEEL CLUTCH	QTY.	REFERENCE #
103126	Steel, Cast Iron powerglide High Clutch .070" 1961-62	5	3779903
103126B	Steel, Cast Iron Powerglide High Clutch .070" (Kolene) 1961-62	5	
108126	Steel, Cast Iron Powerglide High Clutch .070" (6 Teeth) (Flat) 1950-55	5	3703210
108126A	Steel, Cast Iron Powerglide High Clutch .090" (6 Teeth) (Flat) 1957	2	3742398
108126B	Steel, Cast Iron Powerglide High Clutch .070" (6 Teeth) (Waved) 1956-61	5	3764461
108139	Steel Module, Cast Iron Powerglide 1958-62	1	

GM

PART #	MODULATORS	QTY	REFERENCE #
108160	Modulator, Cast Iron Powerglide (Flat Diaphragm) 1950-54	1	3709049
108160A	Modulator, Cast Iron Powerglide (Round Diaphragm) 1958-62	1	3745169

PART #	OIL SEALING RINGS	QTY.	REFERENCE #
108175B	Ring Kit, Cast Iron Powerglide 1955-62	1	
103177	Ring, Cast Iron Powerglide Input Shaft 1950-62	1	

Super Turbine 300



GM

PART #	PAPER & RUBBER KIT	QTY.	REFERENCE #
105000	Paper & Rubber Kit, ST300 1964-69	1	
PART #	OVERHAUL KIT	QTY.	REFERENCE #
105002	Overhaul Kit, ST300 1964-69	1	
PART #	MASTER L/STEEL KIT	QTY.	REFERENCE #
105004	Master L/Steel Kit, ST300 1964-69	1	
PART #	MASTER W/STEEL KIT	QTY.	REFERENCE #
105006	Master W/Steel Kit, ST300 1964-69	1	
PART #	FILTER	QTY.	REFERENCE #
105010	Filter, ST300 1964-69	1	1374649
PART #	FILTER KIT	QTY.	REFERENCE #
105011	Filter Kit, ST300 1964-69	1	
PART #	BANDS	QTY.	REFERENCE #
105022	Band, ST300 (1 7/8" Wide) 1964-69	1	3883918
105022B	Band, ST300 (Hi-Performance) High Pressure Lining	1	
105022H	Band, ST300 (Hi-Performance) Red Lining (1 7/8" Wide)	1	
105022HB	Band, ST300 (Hi-Performance) Racing (2 1/4" Wide)	1	
PART #	BUSHINGS	QTY.	REFERENCE #
105030	Bushing Kit, ST300 1964-69	1	
44034	Bushing, ST300 Pump Body 1964-69	1	8623940
44036	Bushing, ST300 Stator (Front)(Also Low Sun Gear) 1964-69	2	1381366
103046	Bushing, ST300 High Clutch Drum 1964-69	1	3840760
44062	Bushing, ST300 Output Shaft (Front)(Pilot) 1964-69	1	3789034
105064	Bushing, ST300 Case 1964-69	1	1367730
44066	Bushing, ST300 Extension Housing (1.500"ID)(Babbitt) 1964-69	1	6260048
44066B	Bushing, ST300 Extension Housing (1.500"ID)(Babbitt) 1964-69	1	
PART #	METAL CLAD SEALS	QTY.	REFERENCE #
44070	Seal, ST300 Front 1964-69	1	8641826
44072	Seal, ST300 Linkage Shaft 1964-69	1	8623056
44074	Seal, ST300 Rear (W/Flange, W/O Boot) 1964-69	1	1243402
44074C	Seal, ST300 Rear (W/Flange, W/Short Boot) 1964-69		
PART #	FRICTION CLUTCH	QTY.	REFERENCE #
103106	Friction, ST300 High Clutch .098" 1964-69	5	3779904
103106AHP	Friction, ST300 High Clutch .062" (High Performance) 1964-69	5	
103106AHPK	Friction Kit, ST300 High Clutch .060" (High Performance) 1964-69	1	
103106APPK	Friction And Steel Kit, ST300 High Clutch .060" (High Performance) 1964-69	1	
106106HPK	Friction Kit, ST300 High Clutch .098" (Hi-Performance) (5 Per Kit) 1964-69	1	
103106S1	Friction, ST300 High Clutch (.098")(Stage 1) 1964-69	5	
44114	Friction, ST300 Reverse Clutch .070" 1964-69	6	8641512
44114HP	Friction, ST300 Reverse Clutch .098" (Hi-Performance) 1964-69	5	
44114HPK	Friction Kit, ST300 Reverse Clutch .098" (Hi-Performance) (5 Per Kit) 1964-69	1	
44114S1	Friction, ST300 Low/Reverse Clutch (.098") (Stage 1) 1964-69	5-6	
103119HP	Friction Module, ST300 (Hi-Performance) (Indy Reds) 1964-69	1	
105119	Friction Module, ST300 1964-69	1	
PART #	STEEL CLUTCH	QTY.	REFERENCE #
103126	Steel, ST300 High Clutch .070" 1964-69	5	1366440
103126B	Steel, ST300 High Clutch .070" (Kolene) 1964-69	5	
103130	Steel, ST300 Reverse Clutch .070" 1964-69	6	3799210
103130B	Steel, ST300 Reverse Clutch .070" (Kolene) 1964-69	6	

105139.....	Steel Module, ST300 1964-69	1	
PART #	OIL SEALING RINGS	QTY.	REFERENCE #
105175.....	Ring Kit, ST300 1964-69	1	
22177.....	Ring, ST300 Input Shaft 1.125"OD (Metal) 1964-69	2-3	1942041
103179.....	Ring, ST300 High Drum (Metal) 1964-69	2	3689808
105199.....	Ring, ST300 Low Servo Piston (Metal) 1964-69	1	1372058
PART #	WASHERS & BEARINGS	QTY.	REFERENCE #
105211.....	Washer, ST300 Pump to Drum .061" 1964-69	1	1356904
105211A.....	Washer, ST300 Pump to Drum .079" 1964-69	1	1356905
105211B.....	Washer, ST300 Pump to Drum .097" 1964-69	1	1356906
105235.....	Washer, ST300 Drum to Hub 1964-66	1	1362027
105235A.....	Washer, ST300 Drum to Hub 1967-69	1	1377665
103241.....	Washer, ST300 Hub to Sun Gear 1964-69	1	3783286
103250.....	Bearing, ST300 Sun Gear to Planet 1964-69	1	3818528
105253.....	Race, ST300 Planet to Case (Front) 1964-69	1	1366680
105254.....	Bearing, ST300 Planet to Case 1964-69	1	1194558
105255.....	Race, ST300 Planet to Case (Rear) 1964-69	1	1366679
PART #	GASKETS & RUBBER COMPONENTS	QTY.	REFERENCE #
105300.....	Gasket, ST300 Bottom Pan 1964-69	1	1376720
105306.....	Gasket, ST300 Governor Cover 1964-69	1	1359113
105310.....	Gasket, ST300 Pump 1964-69	1	1374598
105334.....	Lip Seal, ST300 High Clutch (Inner) 1964-69	1	
105370.....	O-Ring, ST300 Filler Tube 1964-69	1	
PART #	ELECTRICAL COMPONENTS	QTY.	REFERENCE #
105414.....	Switch, ST300 Spark Control (On Valve Body) 1964-65	1	1943623
105414A.....	Switch, ST300 Spark Control (On Front Pump) 1964-69	1	1993390
105434.....	Solenoid, ST300 Kickdown (W/O Cruise Control) 1964-69	1	1993330
105434A.....	Solenoid, ST300 Kickdown (W/Cruise Control) 1964-69	1	1993374
34444A.....	Connector, ST300 Case (1 Prong) 1964-69	1	24205373
34444B.....	Connector, ST300 Case (2 Prong) 1964-67	1	
PART #	HARD PARTS	QTY.	REFERENCE #
105500.....	Pump Assembly, ST300 Complete (Non-Variable Pitch) 1964-69	1	
105500A.....	Pump Assembly, ST300 Complete (W/Variable Pitch) 1964-65	1	
105500B.....	Pump Assembly, ST300 Complete (W/Variable Pitch) 1966-67	1	
105520A.....	Stator, ST300 (Non Variable Pitch) 1964-69	1	
105520B.....	Stator, ST300 (With Variable Pitch) 1964-67	1	
105530.....	Pump Gear Set, ST300 (.625" Thick)(All Except Cast #123000 On Pump Body) 1964-69	1	
44530AB.....	Pump Gear Set, ST300 (.725" Thick)(With Cast # 123000 On Pump Body) 1964-69	1	
105555.....	Drum, ST300 High Clutch (2.600" Tall)(5.865"OD)(3.060"OD Of The Neck Where Inner Piston O-Ring Rides) 1964-69	1	1361823
105565.....	Piston Kit, ST300 High Clutch Drum 1964-69	1	
105566.....	Piston Kit, ST300 Reverse Clutch 1964-69	1	
105575.....	Hub, ST300 High Clutch 1964-69	1	1380015
105584.....	Planet, ST300 W/14 3/4" Output Shaft 1964-69	1	1380232
105584A.....	Planet, ST300 W/20" Output Shaft 1964-69	1	1380229
105594.....	Ring Gear, ST300 Planet 1964-69	1	1364348
105614.....	Sun Gear Flange, ST300 Planet 1964-69	1	1364366
105670.....	Input Shaft, ST300 (2 Ring Type)(Non-Variable Pitch) 1964-69	1	1384601
105670A.....	Input Shaft, ST300 (3 Ring Type)(W/Variable Pitch) 1964-67	1	1378273
44680.....	Governor Assembly, ST300 1964-69	1	464200
105740.....	Valve Body, ST300 (Non-Variable Pitch) 1964-69	1	
105740A.....	Valve Body, ST300 (W/Variable Pitch) 1964-65	1	
105760.....	Case, ST300 Round Bell 1964-69	1	
105760A.....	Case, ST300 Buick/Olds/Pontiac Bell 1964-69	1	
105765.....	Pan, ST300 Bottom 1964-69	1	
44770.....	Extension Housing, ST300 6" Long, W/2" Speed-O Hole 1964-69	1	
44774B.....	Speed-O Housing, ST300 2" Aluminum 1964-69	1	