

FORD A4LD

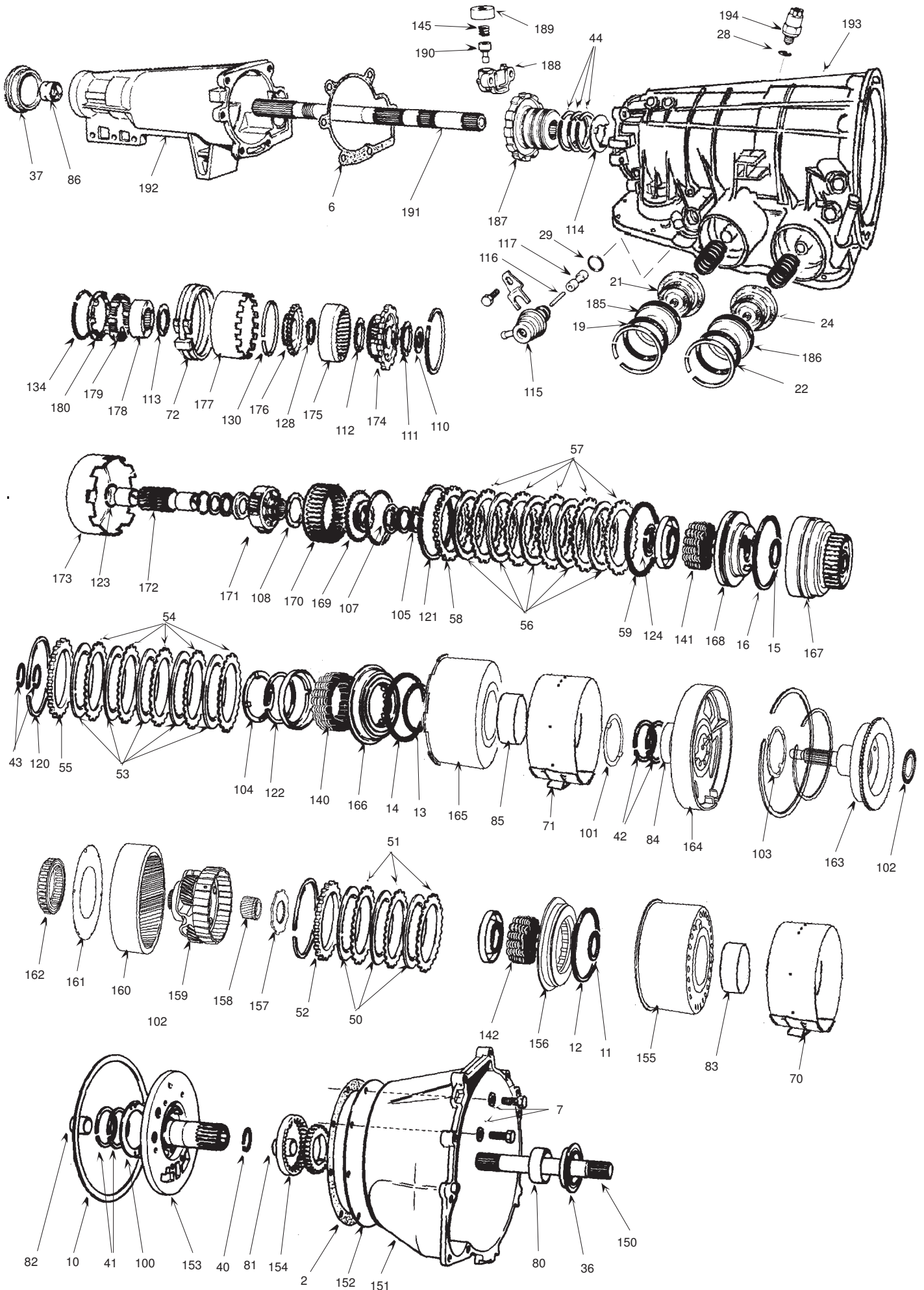

KITS

Overhaul	177 02 01
Overhaul A4LD	177 02 01
Overhaul (with OEM valve body gaskets)	177 02 01A
Overhaul - A4LD Transit & Metrocab diesel	177 02 02
Overhaul - A4LD (with OEM valve body gaskets)	177 02 02A
Overhaul - 4R44E & 4R55E	177 02 04
Overhaul - 5R55E	177 02 05
Overhaul combo 4R44E, 4R55E & 5R55E	177 02 06
Gasket & seal	177 03 01
Shaft sealing ring	- 92 177 06 01
Shaft sealing ring	92 - 177 06 02
Thrust washers	177 10 01
Vent kit replacing breather	177 29 17
Valve body programming kit	177 08 01
Vacuum holding kit - see Vacuum section	
Third & reverse HD clutch pack	177 07 05
Valve body ball & puck kit	177 62 05
Boost valve kit. Large high ratio quick rise A4LD	177 62 03
Boost valve kit. Small low ratio moderate rise A4LD	177 62 04
Boost valve kit. 4R44E	177 62 06
Shift kit 4R44E, 5R55E	177 08 02

GASKETS

NI Pan - Cork	177 25 01
NI Pan - Composite	177 25 09
2 Pump	177 25 02
NI Valve body - lower A4LD only	177 25 05
NI Valve body - upper A4LD only	177 25 06
NI Valve body - lower 4R44E	177 25 08
NI Valve body - upper 4R44E	177 25 07
NI Rear servo	117 25 05
6 Extension	117 25 06
7 Converter housing bolts (alluminium)	117 25 07
NI Case to 4WD unit Explorer only	177 25 13

RUBBER COMPONENTS

10 Converter housing to case lathe cut seal	117 17 01
11 Overdrive clutch inner lathe cut seal	117 17 05
12 Overdrive clutch outer lathe cut seal	117 17 06
13 Third & reverse clutch inner lathe cut seal	84-87 117 17 05
14 Third & reverse clutch outer lathe cut seal	84-87 117 17 06
13 Third & reverse clutch inner lip seal	87- 177 18 01
14 Third & reverse clutch outer lip seal	87-90 117 18 02
14 Third & reverse clutch outer lip seal	90- 177 18 03
15 Forward clutch inner lathe cut seal	117 17 02
16 Forward clutch outer lathe cut seal	117 17 03
17 Reverse servo - large "O" ring	117 16 01
18 Reverse servo - small "O" ring	117 16 02
19 Intermediate servo cover "O" ring	177 16 02
21 Inter servo moulded piston CB 46mm dia	177 45 01
21 Inter servo moulded piston BB 49mm dia	117 29 42
21 Inter servo moulded piston DB 44mm dia	177 45 03
21 Inter servo moulded piston EB 43mm dia	177 45 06
22 Overdrive servo cover "O" ring	177 16 02
24 Overdrive servo moulded piston BB 49mm dia	117 29 42
24 Overdrive servo moulded piston AB 53mm dia	117 29 36
24 Overdrive servo moulded piston ZA & ZC	177 45 07
NI Pipe union "O" ring (4)	113 16 09
NI Speedo "O" ring	117 16 05
NI Kickdown lever shaft "O" ring	117 16 06
NI Pump gear "O" ring for 4R44E	177 16 07
28 Switch "O" ring	117 16 07
29 Modulator "O" ring	117 16 08
NI Shift lever grommet	117 19 01
NI Oil filler "O" ring	117 16 09
NI Valve body balls (5)	117 20 02

NI Filter "O" ring - large	84-85 177 16 05
NI Filter "O" ring - small	84-85 177 16 06
NI Filter "O" ring - large	85- 132 16 07
NI Filter "O" ring - small	85- 177 16 04
NI Converter bolt "O" ring	177 16 01
NI Cooler "O" rings	110 16 01

METAL CLAD SEALS

36 Pump with flange	177 15 03
36 Pump no flange (Transit & late Metrocab)	177 15 02
37 Extension (with boot)	117 15 02
37 Extension (no boot)	117 15 03
Manual control lever	114 15 03

SHAFT SEALING RINGS

40 Stator support to converter - teflon S.J.	(1)	177 26 01
41 Overdrive clutch - teflon S.J.	(2)	117 26 05
42 Aluminium centre support (narrow rubber)	(2)	- 92 177 26 04
42 Aluminium centre support (wide rubber)	(2)	92 - 177 26 06
43 Forward clutch —steel L.J.	(2)	84- 117 26 02
44 Governor - steel L.J.	Either (3)	84-89 117 26 03
44 Governor - rubber full ring	Or (3)	84-89 117 26 04
44 Governor - metal liquid coated	(3)	9/89- 177 26 05

CLUTCH PLATES

50 Overdrive friction 123mm x 1.90 x 32T	(2/3)	84-89 177 11 01
50 Overdrive friction 123mm x 1.70 x 32T	3	89- 177 11 02
50 Overdrive friction 123mm x 1.70 x 32T (rotation)	3	89- 177 11 05
51 Overdrive steel 128mm x 1.70 x 20T	(2/3)	117 12 05
51 Overdrive steel 128mm x 1.65 x 20T	6	89- 177 12 01
52 Overdrive pressure		-89 117 13 02
52 Overdrive pressure		89- 177 13 02
53 Third & reverse friction 125mm x 1.90x 48T	(3/5)	84-90 117 11 01
53 Third & reverse friction 125mm x 1.70 x 48T	(3/6)	90- 177 11 03
53 Third & reverse friction (rotational)	(3/6)	90- 177 11 06
54 Third & reverse steel 128mm x 2.00 x 20T		117 12 01
54 Third & reverse steel 128mm x 1.75 x 20T		84-90 117 12 05
54 Third & reverse steel 128mm x 1.65 x 20T		90- 177 12 01
55 Third & reverse pressure		- 89 117 13 02
55 Third & reverse pressure		89 - 117 13 03
56 Forward clutch friction 118mm x 1.90 x 72T	(3/5)	-89 117 11 02
56 Forward clutch friction 118mm x 1.70 x 72T	(4/6)	89- 177 11 04
56 Forward clutch friction (rotational)	(3/6)	90- 177 11 07
57 Forward steel 122mm x 1.75 x 19T		-89 117 12 06
57 Forward steel 122mm x 1.65 x 19T		89 - 177 12 02
58 Forward pressure		-89 117 13 01
58 Forward pressure		89- 177 13 01
59 Rubber cushion ring		-89 117 12 04
59 Rubber cushion ring		89- 177 24 02

BRAKE BANDS

70 Overdrive	117 14 31
71 Intermediate	117 14 31
72 Reverse (double wrap)	117 14 02

FILTER

NI Pickup	84-85 177 27 01
NI Pickup Sierra / Granada	85-88 177 27 02
NI Pickup Sierra / Granada (short pickup)	88 - 177 27 03
NI Pickup Transit (2" long pickup)	177 27 04
NI Valve body filter	177 27 05
NI Pickup - 4R44E 2WD	177 27 06
NI Pickup - 4R44E 4WD - 47mm pick up	177 27 07
NI Transit - 47mm pick up	96 - 177 27 07
NI Pickup - 5R55E 2WD - no pick up	177 27 08
NI Pickup - 5R55E 4WD - 47mm pick up	177 27 09

BUSHES & BEARINGS

80 Pump - bronze	117 21 01
80 Pump - babbitt	117 21 02
81 Stator support front	(1) 177 21 06
82 Stator support rear	(1) 117 21 03
83 Overdrive drum	177 21 02

**FORD A4LD, 4R44E
4R55E & 5R55E**

4 & 5 speed rear wheel drive, with lock up.

Iss 02/02/2000



Illus	Description	Year	Part No.	Illus	Description	Year	Part No.
84	Centre support nose (external with face)		177 21 01	116	Pin (34.5mm long x 2.45mm dia)		177 28 05
NI	Forward clutch support sleeve		177 21 08	117	Valve (6.40mm dia x 38.00mm long)		177 28 08
NI	Overdrive clutch support sleeve		177 21 09		Sierra TL18, & TL20 Feb 87 to Feb 89		
85	Top & reverse drum		177 21 02	115	Vacuum unit large cannister		117 28 06
86	Extension housing		117 21 07	116	Pin (34.5mm long x 2.45mm dia)		177 28 05
NI	Output shaft front early 11.20mm x 14 x 10		177 21 03	117	Valve (6.40mm dia x 38.00mm long)		177 28 08
88	Output shaft front late 10.00mm x 14 x 10		177 21 04		Sierra TV28 Mar 85 to Jan 87		
NI	Case bush for output shaft		117 21 09	115	Vacuum unit small cannister (silver)		177 28 03
NI	Case governor feed bore salvage sleeve		177 21 05	116	Pin (34.5mm long x 3.13mm dia)		177 28 06
				117	Valve (9.16mm dia x 40.89mm long)		177 28 07
					Sierra TV28 Jan 87 to Feb 89		
				115	Vacuum unit		177 28 09
				116	Pin (34.5mm long x 3.13mm dia)		177 28 06
				117	Valve (9.16mm dia x 40.89mm long)		177 28 07
					Granada TL20 to Dec 86		
				115	Vacuum unit small cannister (gold)		177 28 01
				116	Pin (34.5mm long x 2.45mm dia)		177 28 05
				117	Valve (9.16mm dia x 40.89mm long)		177 28 07
					Granada TL20 Dec 86 to Feb 89		
				115	Vacuum unit large cannister		117 28 06
				116	Pin (34.5mm long x 3.13mm dia)		177 28 06
				117	Valve (9.16mm dia x 40.89mm long)		177 28 07
					Granada TV2.4 Sep 86 to Dec 86		
				115	Vacuum unit small cannister (gold)		177 28 01
				116	Pin (34.5mm long x 2.45mm dia)		177 28 05
				117	Valve (9.16mm dia x 40.89mm long)		177 28 07
					Granada TV24 Dec 86 to Feb 89		
				115	Vacuum unit large cannister		117 28 06
				116	Pin (34.5mm long x 3.13mm dia)		177 28 06
				117	Valve (9.16mm dia x 40.89mm long)		177 28 07
					Granada TV28 to Feb 89		
				115	Vacuum unit small cannister (silver)		177 28 03
				116	Pin (34.5mm long x 2.45mm dia)		177 28 05
				117	Valve (9.16mm dia x 40.89mm long)		177 28 07
					Granada TV29 Sep 86 Dec 86		
				115	Vacuum unit small cannister (gold)		177 28 01
				116	Pin (34.5mm long x 2.45mm dia)		177 28 05
				117	Valve (9.16mm dia x 40.89mm long)		177 28 07
					Granada TV 29 Dec 86 Feb 89		
				115	Vacuum unit large cannister		117 28 06
				116	Pin		177 28 06
				117	Valve (9.16mm dia x 40.89mm long)		177 28 07
					Transit Feb 89 on		
				115	Vacuum unit large cannister		117 28 06
				116	Pin		177 28 06
				117	Valve (9.16mm dia x 40.89mm long)		177 28 07
				115	MetroCab Vacuum unit small cannister (gold)		177 28 01
					General use		
				115	Adjustable large cannister		177 28 04
				115	Adjustable Rostra modulator		177 28 13
					Vacuum holding system kit Ford TSB 86 comprising-		
					Solenoid valve		177 35 03
					Vacuum sustain valve		177 28 10
					"T" piece (2)		177 28 11
					Vacuum hose 0.50 metre		177 28 12
				115	Vacuum mod 117 28 06 replaced by electronic version mid 1997		177 35 01
					CIRCLIPS		
				120	Third & reverse clutch selective 1.37mm		177 32 01
				120	Third & reverse clutch selective 1.73mm		117 32 02
				120	Third & reverse clutch selective 2.08mm		117 32 03
				120	Third & reverse clutch selective 2.44mm		117 32 04
				121	Forward clutch selective 1.37mm		117 32 05
				121	Forward clutch selective 1.73mm		117 32 06
				121	Forward clutch selective 2.08mm		117 32 07
				121	Forward clutch selective 2.44mm		117 32 08
				122	Third & reverse spring retainer		117 32 09
				123	Sun gear (2)		117 32 10
				124	Forward spring retainer		117 32 11
				128	Ring gear to output shaft		117 32 16
				NI	Rear servo		117 32 17
				130	Reverse gearset hub to ring gear (2)		117 32 18
				NI	Control rod		117 32 1
				132	Governor rod (early)		117 32 20
				NI	Governor to output shaft (early)		117 32 21
					VACUUM MODULATOR		
					Sierra TL18, TL20, & TV23 to Jan 87		
115					Vacuum unit small cannister (gold)		177 28 01
100	Rear of pump selective 1.40mm Stamp 1		177 22 04				
100	Rear of pump selective 1.60mm Stamp 2		117 22 03				
100	Rear of pump selective 1.80mm Stamp 4		117 22 14				
100	Rear of pump selective 2.00mm Stamp 6		177 22 06				
100	Rear of pump selective 2.20mm Stamp 5 or B		177 22 07				
100	Rear of pump selective 2.40mm Stamp C		117 22 05				
100	Rear of pump selective 2.60mm		177 22 14				
100	Rear of pump selective 2.80mm Stamp E		117 22 06				
101	Rear of C/support selective 1.40mm Stamp 1	-1/92	177 22 04				
101	Rear of C/support selective 1.60mm Stamp 2	-1/92	117 22 03				
101	Rear of C/support selective 1.80mm Stamp 4	-1/92	117 22 14				
101	Rear of C/support selective 2.00mm Stamp 6	-1/92	177 22 06				
101	Rear of C/support selective 2.20mm Stamp 5 or B	-1/92	177 22 07				
101	Rear of C/support selective 2.40mm Stamp C	-1/92	117 22 05				
101	Rear of C/support selective 2.60mm	-1/92	177 22 14				
101	Rear of C/support selective 2.80mm Stamp E	-1/92	117 22 06				
101	Rear c/support ndl small No 5 41 x 54 x 4.00mm	92-	177 23 06				
101	Rear c/support ndl small No 5 41 x 54 x 3.80mm	92 -	177 23 07				
101	Rear c/support ndl small No 5 41 x 54 x 3.60mm	92 -	177 23 08				
101	Rear c/support ndl small No 5 41 x 54 x 3.40mm	92 -	177 23 09				
101	Rear c/support ndl large No 4 3.35mm	0895	177 23 10				
101	Rear c/support ndl large No 4 3.15mm	0895	177 23 11				
101	Rear c/support ndl large No 4 2.95mm	0895	177 23 12				
101	Rear c/support ndl large No 4 2.80mm	0895	177 23 13				
101a	Rear c/support ndl large No 4 3.35mm	95 -	177 23 10				
101a	Rear c/support ndl large No 4 3.15mm	95 -	177 23 11				
101a	Rear c/support ndl large No 4 2.95mm	95 -	177 23 12				
101a	Rear c/support ndl large No 4 2.80mm	95 -	177 23 13				
102	O/D carrier to O/D hub needle 52mm/20mm/46N		177 23 01				
102	O/D g/set needle thrust		183 23 03				
103	Ally c/support - front 76mm/62.5mm/2legs	84-91	177 22 03				
103	Ally c/support needle thrust Number 3	92 -	177 23 05				
104	Inter to fwd drum 78mm/58mm/4legs		177 22 01				
105	Fwd g/set to fwd clutch 38mm/26mm/3legs	84/87	117 22 08				
105	Fwd g/set to fwd clutch (non-circlip)	87 on	177 22 08				
105	Fwd g/set brass top hat		177 22 09				
107	Fwd g/set (under circlip) 48mm/38mm/4legs		117 22 10				
108	Forward gearset carrier to hub needle	84/87	177 23 02				
108	Forward gearset carrier to hub needle	87 on	177 23 03				
110	Sun gear shell 75mm/27 int spline		117 22 11				
111	Reverse planet - front 70mm/52mm/6legs		117 22 09				
111	Reverse planet - front 70mm/52mm/1.6		117 22 19				
112	Reverse planet - rear 70mm/52mm/6legs		117 22 09				
112	Reverse planet - rear 76mm/52mm/1.6		117 22 20				
113	Output ring gear hub 58mm/37mm/3legs		117 22 12				
113	Output ring gear hub 50mmx61mmx1.60mm		177 22 15				
113	Output ring gear hub 50mmx80mmx1.60mm		177 22 16				
113	Output ring gear hub 4R44E		177 23 14				
114	Case to governor hub 58mm/31mm/3legs		117 22 13				
NI	Overdrive planet 1.000" x 0.456" x 0.033"		177 22 12				
NI	Forward & reverse gearset shim 0.015"		177 22 17				
NI	Forward & reverse gearset shim 0.030"		177 22 18				



Iss 02/02/2000

4 & 5 speed rear wheel drive, with lock up.

**FORD A4LD, 4R44E
4R55E & 5R55E**

Illus	Description	Year	Part No.	Illus	Description	Year	Part No.
134	One way clutch		117 32 22	167	Forward drum - 6 plate		177 29 25
	SPRINGS			168	Forward piston		117 29 56
140	Third & reverse clutch return nest	(20)	117 24 01	168	Forward piston		117 29 56
141	Forward clutch return nest	(15)	117 24 02	169	Forward ring gear hub A4LD		177 66 03
142	Overdrive clutch return nest			169	Forward ring gear hub 4R44E		177 66 11
NI	Rear servo - large		117 24 03	170	Forward ring gear		117 29 24
NI	Rear servo - small		117 24 10	171	Forward planet assembly	10/87 to 6/89	177 66 04
NI	Park pawl		117 24 04	171	Forward planet assembly	6/89 on	177 66 05
NI	1-2 shift valve (reduces hard shift)		117 24 05	171	Forward planet assembly - 6 planets		177 66 09
NI	Lock up valve return		177 24 01	172	Sun gear		117 29 33
145	Governor valve (early)		117 24 06	173	Input shell		117 29 34
145	Governor valve (late)		117 24 07	174	Reverse planet assembly		117 29 26
NI	Kickdown lever		117 24 08	174	Reverse planet assembly - 6 planets		177 66 10
NI	Front servo		117 24 09	175	Output ring gear (early)		117 29 27
NI	Converter shift spring (anti shudder)		177 24 04	175	Output ring gear (early)		177 66 08
	HARD PARTS			176	Output ring gear hub (early)		117 29 30
150	Input shaft		177 64 01	176	Output ring gear hub (early)		117 29 29
151	Bell housings			176	Output ring gear hub 4R44E		177 29 30
	Sierra/Granada TL eng	10/84 to 6/87	177 55 01	177	Reverse band drum (for roller type OWC)	-6/92	117 29 31
	Sierra/Granada TL eng	6/87 on	177 55 02	177	Reverse band drum (including sprag type OWC)	6/92-	177 29 27
	Sierra/Granada TV eng	10/84 to 6/87	177 55 03	178	Roller clutch inner race		117 44 03
	Sierra/Granada TV eng	6/87 on	177 55 04	179	Roller clutch accordion springs	(10)	117 29 83
	Sierra HL18	04/88 on	177 55 05	179	Rollers	(10)	117 29 84
	Transit TL	11/88 on	177 55 02	180	Roller clutch spring retainer		117 29 85
	Transit diesel 2.5	11/88 on	177 55 06	179	Sprag type OWC - replaces roller type	94 -	177 44 03
152	Pump wear plate	84 to 85	177 38 02	185	Inter servo cover	46mm dia	177 29 06
152	Pump wear plate	85 to 5/87	177 38 03	185	Inter servo cover	49mm dia	117 29 87
152	Pump wear plate	6/87 on	177 38 04		Inter servo cover fix kit		177 45 05
153	Pump assembly	84 to 6/87	177 38 01	186	Overdrive servo cover	49mm dia	117 29 87
153	Pump assembly (Allen bolt type)	6/87 to 02/91	177 38 05	186	Overdrive servo cover	53mm dia	117 29 88
153	Pump assembly (Allen bolt type)	02/91 on	177 38 06	187	Governor hub		
154	Pump gears (set)		117 29 11	188	Governor body		117 29 77
154	Pump gears (0.025" oversize diameter)		117 29 57	189	Governor weight		117 29 78
155	Overdrive clutch assembly A4LD	6/89 -	177 29 16	190	Governor valve 2.3 litre		117 29 80
155	Overdrive clutch assembly 4R44E			190	Governor valve 2.0 & 2.8 litre		117 29 81
155	Overdrive drum available seperately			191	Output shaft - with 6 start speedo drive		177 57 01
156	Overdrive clutch piston		117 29 44	NI	Speedo driven gear 19 teeth Sierra & Transit		177 60 02
157	Overdrive sun adaptor plate		177 65 02	NI	Speedo driven gear 20 teeth Sierra & Transit		177 60 03
158	Overdrive sun		177 65 01	192	Ext housing	Cas ref AA	177 54 01
159	Overdrive planet gear carrier		177 66 01	192	Ext housing	Cas ref AC	177 54 02
160	Overdrive ring gear	84-89	177 66 02	192	Ext housing (with speedo hole)	Cas ref ABR	177 54 03
161	Overrun sprag retaining plate		177 29 09	192	Ext housing (no speedo - Transit)	Cas ref ABR	177 54 04
162	Overrun sprag clutch	-6/92	177 44 01	193	Case - Sierra TL18, TL20L/H, TV23, TL20L/H		177 53 01
162	Overrun sprag clutch	6/92-	177 44 02	193	Case - Sierra & Granada TL20L, TV28l		177 53 02
163	Overdrive OWC shaft only outer	84-89	177 66 06	193	Case - for late sprag type OWC		177 53 03
163	Overdrive OWC shaft only outer	89 -	177 66 07	NI	Breather assembly		177 29 28
164	Aluminium centre support	2/92	177 43 03	NI	Rear servo piston		117 29 15
164	Aluminium centre support	2/92	-5/93		Detent roller & spring		117 29 38
164	Aluminium centre support	5/93-	177 43 05		Selector rod securing clip (ext)		177 29 15
165	Third & reverse drum - TL18, TL20, & TV23		177 29 04		Band adjuster lock nut	(2)	117 29 01
165	Third & reverse drum - TV28l		177 29 05		Rear servo rod 84.65mm		117 29 03
165	Third & reverse drum - Granada	8/92-	177 29 10		Rear servo rod 86.35mm		117 29 04
165	Third & reverse drum - Cosworth	8/92-	-12/92		Rear servo rod 88.05mm		117 29 05
165	Third & reverse drum - Cosworth	12/92-	177 29 20		T/C house to eng. seperater plate 2.4 & 2.9		117 29 59
165	Third & reverse drum - 6 friction		177 29 26		Manual valve index		177 62 03
165	Third & reverse drum late - 5 friction	93-	177 29 23				
165	Third & reverse drum snap in type		177 29 30				
166	Third & reverse piston	84-87	117 29 44				
166	Third & reverse piston	87-	177 45 02				
166	Third & reverse piston late	93-	177 45 04				
167	Forward drum - 3 plate		117 29 51				
167	Forward drum - 4 plate		177 29 14				
167	Forward drum - 5 plate early		117 29 53				
167	Forward drum - 5 plate late		177 29 11				

**FORD A4LD, 4R44E
4R55E & 5R55E**

4 & 5 speed rear wheel drive, with lock up.



Illus	Description	Year	Part No.	Illus	Description	Year	Part No.
	ELECTRICAL						
194	Inhibitor switch 3 prong		117 35 01				
194	Inhibitor switch 4 prong		117 35 20				
194	Inhibitor switch 4R44E		177 35 16				
	Speedometer sensing head		177 60 01				
	Computer speed sensor	06/89 -	01/90 177 35 10				
	Computer speed sensor		01/90- 177 35 11				
	Computer speed sensor 4R44E		10/95- 177 35 14				
	Lockup solenoid		177 35 02				
	Lockup solenoid 4R44E		177 35 18				
	Pressure regulator 4R44E		177 35 19				
	Throttle position sensor (no lead)		177 35 23				
	Throttle position sensor (with lead)		177 35 12				
	Shift solenoid 4R44E		177 35 17				
	Lockup insulated connector	-01/87	177 35 05				
	Lockup insulated connector	01/87-	177 35 06				
	Lockup insulated connector DL 20H engine	05/89-	177 35 06				
	Lockup insulated connector DL 20i & TV,CV29 eng	05/89-	177 35 07				
	Valve body loom 2.0 DOHC		177 35 13				
	Kickdown solenoid	-04/89	177 35 01				
	Kickdown solenoid	04/89 to	04/92 177 35 04				
	Kickdown solenoid	05/92 to	10/94 177 35 26				
	Kickdown relay		177 35 15				
	3 - 4 shift solenoid	06/89 to	08/90 177 35 08				
	3 - 4 shift solenoid		08/90- 177 35 09				
	3 - 4 shift solenoid plug		177 62 01				
115	Electronic modulator	mid 97 on	177 35 21				
	Centre support sensor		177 35 27				
	TORQUE CONVERTERS						
	Granada 2000 etc	Hi stall 21mm spig	6 177 30 01				
	Granada 2.9 no catalyist	Lo stall 21mm spig	5,7,14 177 30 02				
	Granada 2000 DOHC	Hi stall 36mm spig	10 177 30 03				
	Metro Cab	Hi stall with R/G	177 30 04				
	Metro Cab	Lo stall 21mm spig. Full splines	7 177 30 05				
	Transit diesel	Hi stall 21mm spig. Full splines	177 30 06				
	Cosworth	Lo stall 21mm spig hard spline	177 30 07				
	Transit late	Hi stall 21mm spig	177 30 08				
	4 litre V6 USA vehicles only (twin friction)		177 30 09				
	Granada 2000 DOHC	Hi stall 36mm spig	3 177 30 10				
	Metro Cab with ring gear	Lo stall 21mm spig	177 30 11				
	Explorer		177 30 13				
	Cosworth 4R44E	Lo stall 21mm spig	2 177 30 14				
	Granada 2.3 DOHC	Lo stall 36mm spig	177 30 15				
	Aerostar A4LD		177 30 16				
	TOOLS						
	Forward clutch sleeve tool		177 33 08				
	Overdrive clutch sleeve tool		177 33 07				